



3-15
TP20297, Rev 2

Honda CRV



BOLT TORQUE SPECIFICATIONS

STANDARD BOLTS:			METRIC BOLTS:	
Size	Grade	Torque	Size	Torque
5/16"	5	20 ft/lbs.	8mm	22 ft/lbs.
3/8"	5	35 ft/lbs.	10mm	42 ft/lbs.
7/16"	5	56 ft/lbs.	12mm	70 ft/lbs.
1/2"	5	85 ft/lbs.	14mm	95 ft/lbs.

BASEPLATE

Pin Height: 16" Centers: 23"

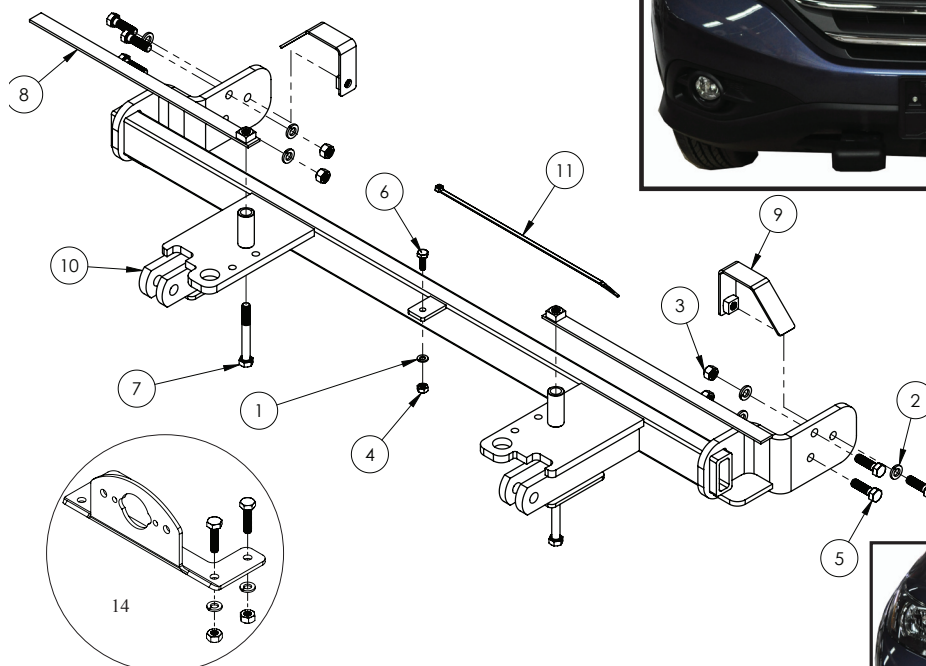

9518297 PARTS LIST

REF. NO.	PART NO.	QTY.	DESCRIPTION
1.	00057	2	1/4" Lockwasher
2.	00060	6	3/8" Lockwasher
3.	00061	4	3/8" Hex nut
4.	00062	2	1/4" Hex nut
5.	00523	6	3/8"-NC x 1-1/4" Hex Bolt Gr.5
6.	01076	2	1/4"-NC x 3/4" Hex Bolt Gr.5
7.	02207	2	3/8"-NC x 3" Hex Bolt Gr.5
8.	10382-35	2	Nut Strip
9.	12554-35	2	Nut Strip, Bent
10.	14421-30	1	Base plate Crossmember
11.	NHT11	1	Hose Tie 11"
12.	12979	1	Pull Ear Cover "A"
13.	12980	1	Pull Ear Cover "B"
14.	5937	1	Plug Mount Kit
15.	12329	1	Loctite (not shown)

Please order replacement parts by PART NO. and DESCRIPTION.

ASSEMBLY
OPERATION
REPLACEMENT PARTS

READ complete manual CAREFULLY
BEFORE attempting operation.

Doing Our Best to Provide You the Best

WARRANTY POLICY & REGISTRATION

Go online to www.demco-products.com to review Demco warranty policies and register your Demco product.

WARNING: FAILURE TO FOLLOW THESE INSTRUCTIONS CAN RESULT IN LOSS OF TOWING VEHICLE CONTROL, SEPARATION OF THE TOW BAR FROM THE TOWING VEHICLE, SEPARATION OF THE TOWED VEHICLE FROM THE TOW BAR, CAUSING SEVERE PERSONAL INJURY, DEATH, OR PROPERTY DAMAGE.

CAUTION

Safety is of utmost importance at all times. There are several items that must be checked each time before using and while using a tow bar.

Before allowing anyone to hook up or operate a tow bar, be sure they have read and understand the proper operating procedure.

DO NOT use worn or damaged cables and/or pins.

Be sure the **SAFETY CABLES** are hooked, chassis to chassis, to both the towing and towed vehicles using the crisscross method.

Check clearance between vehicles in a turning situation.

Check base plate mounting bolts for tightness and frame for metal fatigue.

Do not load the towed vehicle with anything as you may exceed the towing capacity of the tow bar.

Keep fingers away from pivot points to prevent personal injury.

Be sure the steering components of the towed vehicle are properly aligned.

NOTE: This unit can be backed up in moderate increments. Any severe backwards cornering could result in damage to the Tow Bar and/or towed vehicle chassis.

For automatic transmissions: Consult your vehicle owners manual for towing suitability with the drive shaft connected. Otherwise, the towed vehicle will have to be equipped with a transmission pump or drive shaft disconnect.

Check to make sure that all lights are in proper working order.

The information on towability of vehicles is reprinted with permission of MotorHome® Magazine, and is believed to be reliable. However, Demco does not warrant the information to be correct. Always consult your towed vehicle owner's manual and follow towing instructions. Each year, MotorHome® Magazine, compiles a list of vehicles that can be towed four-down behind a motorhome with no modifications required. This guide contains only those vehicles that have been approved by their manufacturers for towing.

 **Caution: MotorHome® Magazine** left out any vehicles that have towing speed limits slower than 55 m.p.h., or distance limits of less than 200 miles. At a minimum, these vehicles require significant modification, such as the use of an aftermarket product, to make them towable. The availability of a **Demco Tow Bar Base Plate** does **not** imply that these vehicles can be modified or that there is an aftermarket product available. Refer to your vehicle owner's manual or consult your dealer to determine whether your vehicle can be modified to make it towable. Failure to observe this precaution could result in property damage or personal injury.

IMPORTANT INSTALLATION ITEMS

DEMCO products and accessories are intended to be installed by professional installers with experience, proper equipment and the ability to do modification work. Installers with these qualifications can be found in RV and Automotive Service Centers.

If the car to be towed has been in an accident, the chassis may be damaged in an area where the Base Plate attaches. It may no longer be suitable for towing. Extreme caution and careful examination are required in such a situation. It is also likely, even from a minor accident, that the hole alignment will be more difficult due to hole alignment problems.

Many DEMCO Base Plates are designed to use existing holes and hardware to mount the Base Plate to the towed vehicle. Even though the bolt is there, however, do not assume it is adequate for mounting the Base Plate. Manufacturers make many changes in hardware both within and between model years. Be sure the bolt is long enough to protrude past the nut a distance no less than 1/2 the diameter of the bolt, after the Base Plate is mounted. The threads should be in good condition. **We require that "LOCTITE® Blue" be used on all bolts.** If a new bolt is required, be sure it is SAE Grade 5 or Metric 8.8.

NOTE: The dimensional variations between otherwise identical vehicles can be considerable. Some minor modifications may have to be made to ensure a proper fit.

INSTALLATION INSTRUCTIONS

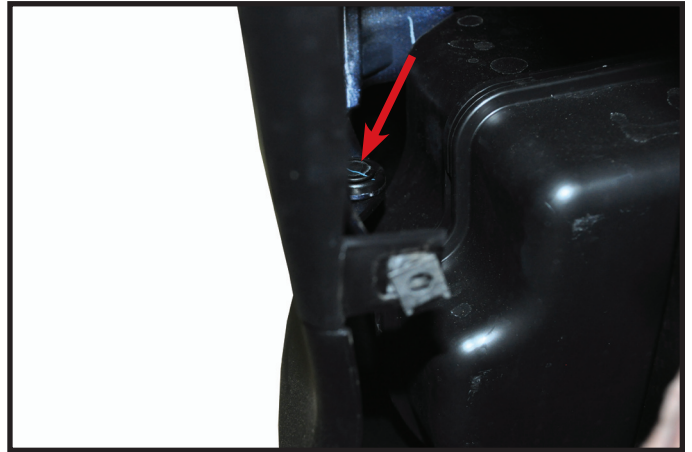

3. Carefully pull back inner wheel well and remove one plastic push fastener from each side.



1. Remove three plastic push fasteners and one screw from each wheel well.



4. Remove four plastic push fasteners from bottom side of fascia near lower grill opening.

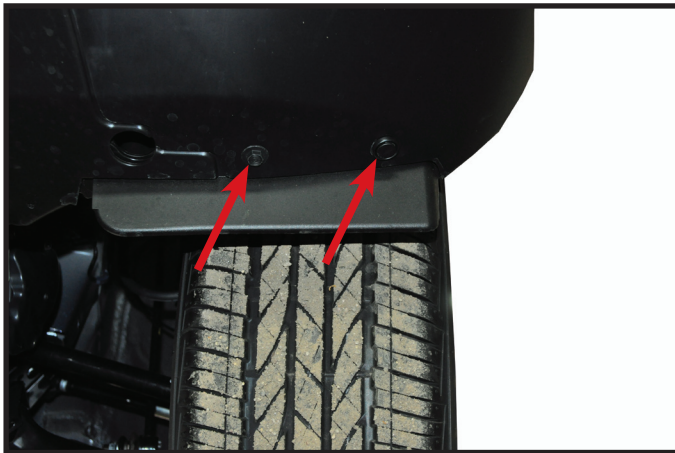

2. Remove one screw and one plastic push fastener from bottom of fascia in front of each wheel.

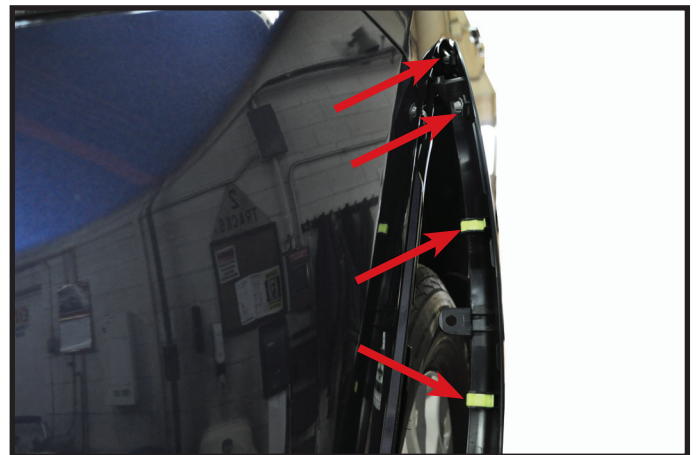

5. Carefully pull back inner wheel well and release the two yellow clips of the fender flare by squeezing on each side. After releasing the yellow clip carefully release the two gray plastic fasteners higher up on the fender flare. Repeat on opposite side also.



6. Remove one screw from fascia on both sides.

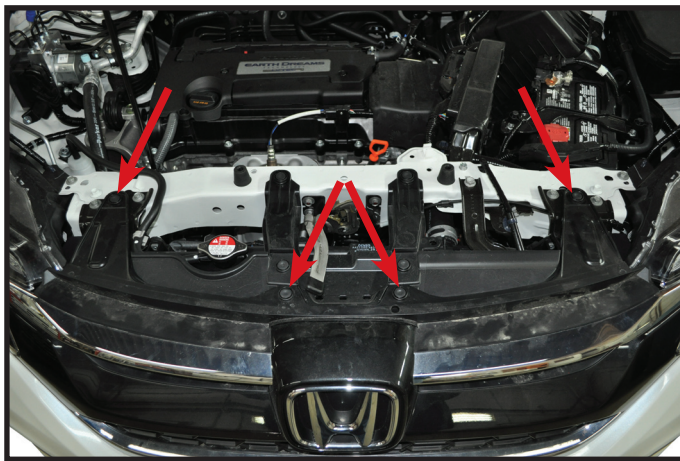

7. **2015 & newer:** Remove four plastic push fasteners from the top of fascia.



8. Pull out and forward from each side of fascia till outer portion is released just leaving the grill portion connected. 2015 the fascia will be loose unplug fog lights and set fascia aside and skip to step 11. **NOTE:** A screwdriver or similar tool may be used below head lights to release three clips from each side.



9. Release four yellow plastic clips from behind grill by pulling outward on the chrome grill and reaching up and behind to release them. While pulling forward on grill press small tab on bottom in till you feel grill move slightly then squeeze side tabs till grill moves forward a little more and then press in small tap on top to release clip. **NOTE:** Start on passenger side and work your way to drivers side.

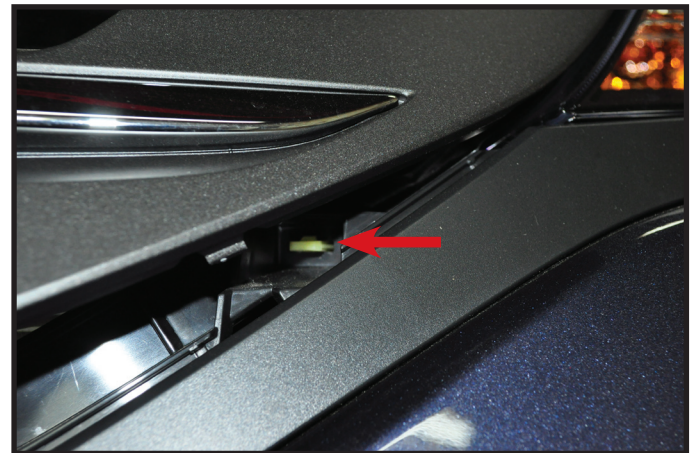

10. Pull grill forward and on each side of the grill use a screwdriver and press down on yellow tab to release the fascia. Once fascia is released pull forward and down and disconnect fog lights if equipped and set fascia aside. **NOTE:** Be careful when tabs are release fascia may fall forward so make sure to have an assistant help.

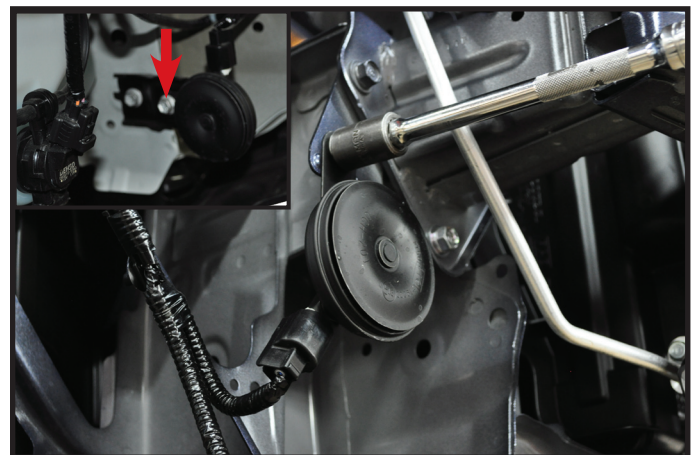

11. On passenger side remove one bolt from horn and let horn hang. Inset picture is of 2015 and newer models.

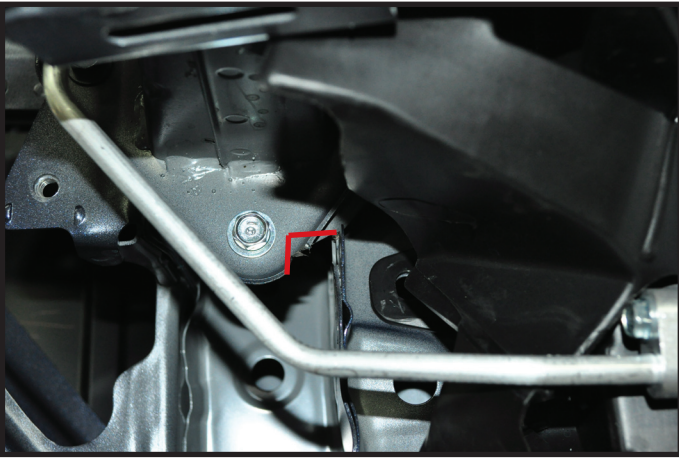

12. On each side of the vehicle trim 1/8" away as shown in the picture from the bottom inside of the bumper mount.

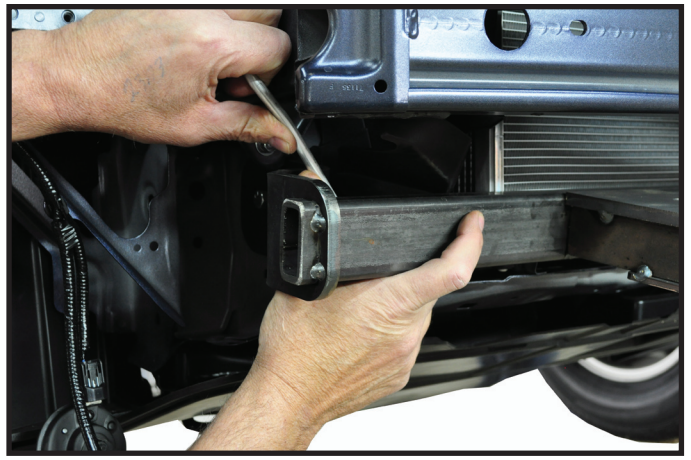

15. With base plate hanging down at an angle use both hands to move and bend the cooler line. Slowly and carefully pivot base plate up to the bumper to make sure line clears base plate. **NOTE:** Wrap the adjusted cooler line with some hose or something similar if so choose.



13. Trim air deflectors as shown by lines in each picture.

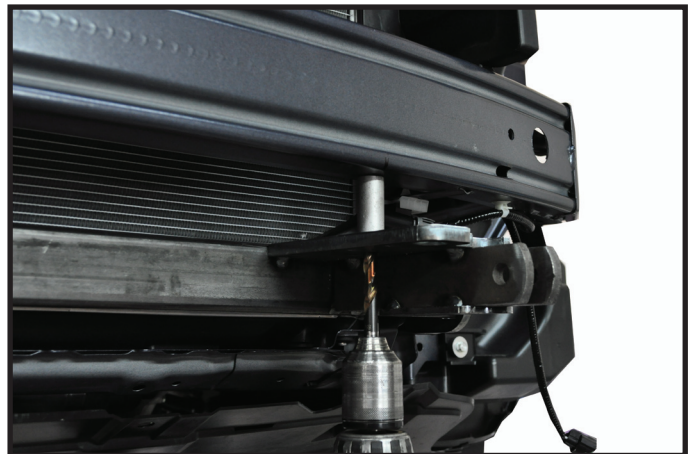

16. Pivot base plate upwards till bushings are tight against bumper and drill a 3/8" hole through bottom of bumper using the base plate as a jig.

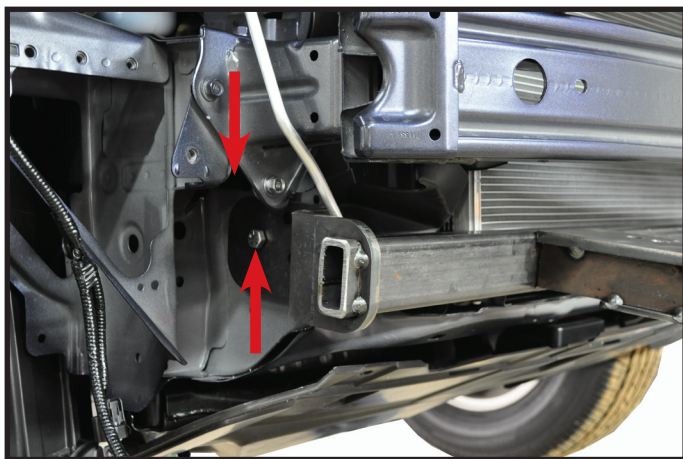

14. Slide base plate into position (A screwdriver may be used to help slide mounting tabs on to frame) by lining up rear base plate hole with existing hole in frame. Put nut strip into large hole in frame and fasten with 3/8" locknut and 3/8" x 1-1/4" bolt. **NOTE:** Use Blue **LOCTITE**® on threads and tighten bolts according to bolt chart on front page.

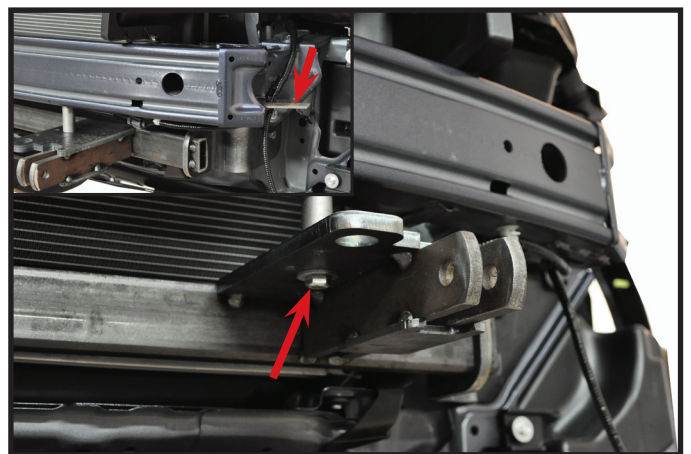

17. Using a 3/8" x 3" bolt and nut strip slid in from the end of the bumper fasten the base plate to the bumper and tighten. **NOTE:** Use Blue **LOCTITE**® on threads and tighten bolts according to bolt chart on front page.

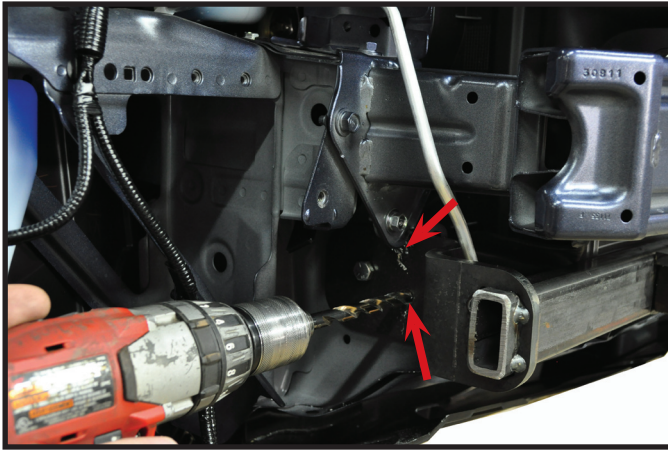

18. Drill two 3/8" holes through base plate mounting plates on each side using the base plate as a jig.

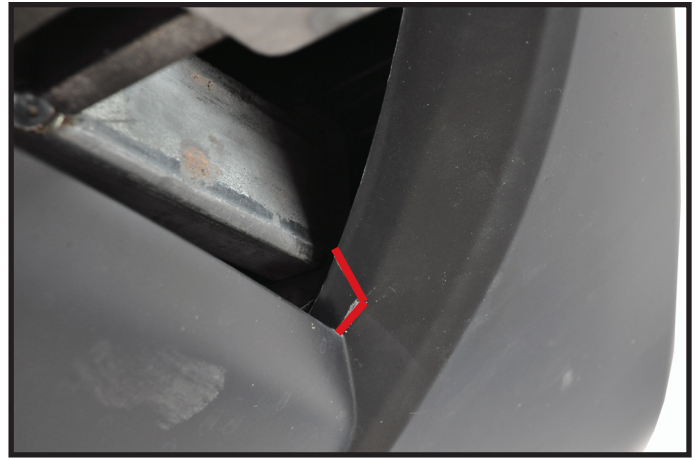

20. On each side of facia trim as shown by lines in the picture on the bottom outside corner of the outer lower openings in the facia. Bottom picture is for 2015 and newer.

21. Reinstall horn and facia in reverse order. Plug mount (item #14) may be installed if desired in convenience holes on either chain anchor or as desired. **NOTE:** Excess material may be trimmed from bracket.

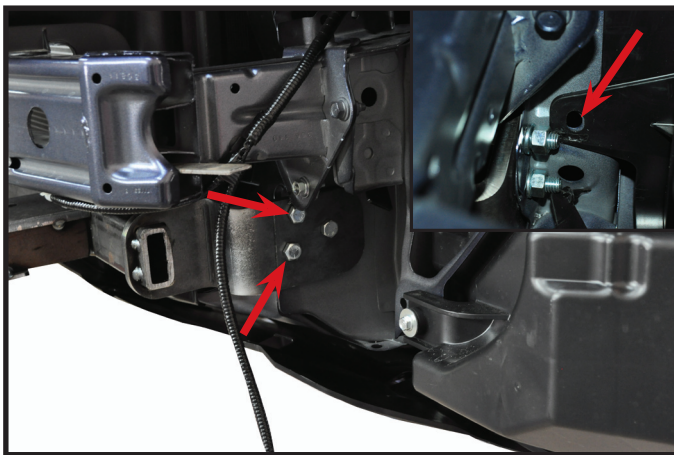

19. Using 3/8" x 1-1/4" bolts, 3/8" lock washers, and 3/8" hex nuts fasten the base plate to the frame and tighten. For ease of installing bolts one plastic push fastener on the inside of frame may be removed on each side as show in insert picture and reinstalled after bolts are tight. **NOTE:** Use Blue **LOCTITE**® on threads and tighten bolts according to bolt chart on front page.

NOTES



P.O. BOX 189
4010 320th St., BOYDEN, IA. 51234
PH: (712) 725-2311
FAX: (712) 725-2380
TOLL FREE: 1-800-54DEMCO (1-800-543-3626)
www.demco-products.com

**Go online to www.demco-products.com for Demco
warranty policies & product registration.**