



MOUNTING BRACKET KIT INSTALLATION INSTRUCTIONS

ROADMASTER, Inc. 6110 NE 127th Ave. Vancouver, WA 98682 1-800-669-9690 fax 360-735-9300 www.roadmasterinc.com

PARTS LIST:

- 1- MAIN BRACE (A) - Passenger side
- 1- MAIN BRACE (B) - Driver's side
- 1- FRONT BRACE (C) - Passenger side
- 1- FRONT BRACE (D) - Driver's side
- 1- EXTENSION PLATE (E) - Passenger side
- 1- EXTENSION PLATE (F) - Driver's side

KIT NO. 1411-2

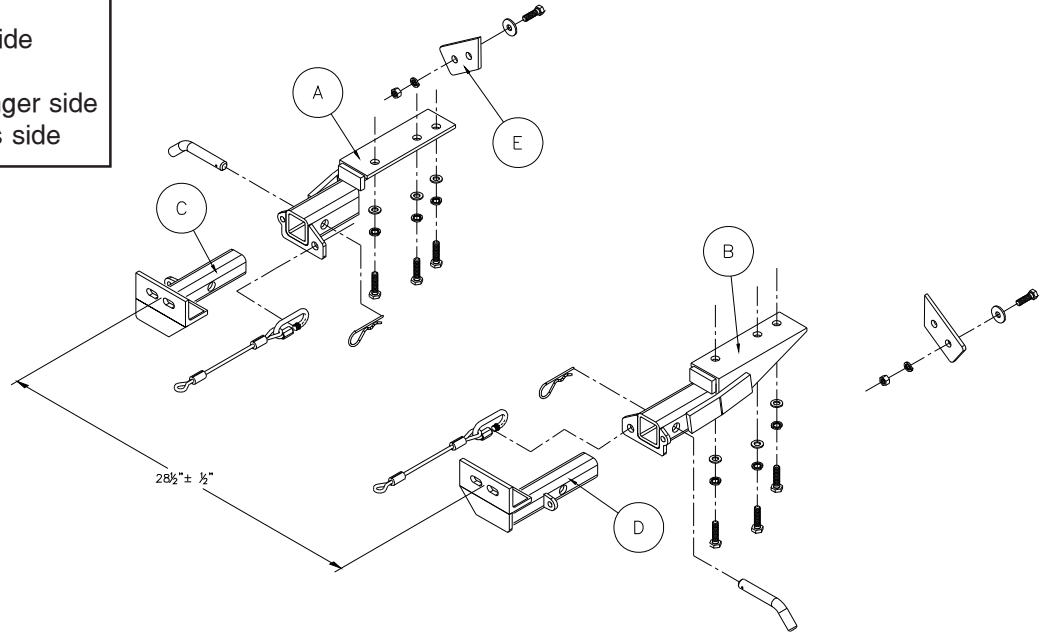

02-11-11

IMPORTANT: All brackets *must* be assembled with all the bolts left loose for final adjustment and positioning (before tightening) unless otherwise instructed. All bolts *must* be torqued for proper strength. If more than one bolt is used per fastening point, the diagram may only show one.

- Use flat washers over all slotted holes
- Use lock washers on all fasteners

ROADMASTER Limited Warranty, including One-Year Conditional Warranty Text and Product Registration Card, in Carton.

WARNING

Failure to follow these instructions can result in property damage, personal injury or even death.

- Installation of most mounting brackets requires moderate mechanical aptitude and skills. We strongly recommend professional installation by an experienced installer.
- The installer must read the instructions and use all bolts and parts supplied. Failure to do so could result in loss of the towed vehicle.
- Use Loctite® Red on all bolts used for mounting this bracket.
- Do not use this document for custom fabrication, as it may not show all parts or structural components. Custom fabrication or an attempt to copy this bracket design could result in loss of the towed vehicle.
- Every 3,000 miles, the owner must inspect the fasteners for proper torque, according to the bolt torque requirements chart on the last page of these instructions. The owner must also inspect all mounts and brackets for cracks or other signs of fatigue every 3,000 miles. Failure to do so could result in loss of the towed vehicle.
- The owner must check the vehicle manufacturer's instructions for the proper procedure(s) to prepare the vehicle for towing. Some vehicles must be equipped with a transmission lube pump, an axle disconnect, driveline disconnect or free-wheeling hubs before they can be towed. Failure to properly equip the vehicle will cause severe damage to the transmission.
- If running changes were made by the vehicle manufacturer after this bracket was designed, some bolts or other fasteners in the hardware pack may no longer be the correct size. It is the installer's responsibility to verify that the bracket is securely fastened to the vehicle and fitted with the correct hardware to account for these changes. Failure to securely fasten the bracket could result in loss of the towed vehicle.
- If the towed vehicle has been in an accident, it must be properly repaired before attaching the bracket. Do not install the bracket if any structural frame damage is found. Failure to repair the damage could result in the loss of the towed vehicle.
- Some motorhome chassis have such a tight turning radius that you can damage your motorhome, towed vehicle, tow bar or bracket while turning sharply. Before getting on the road, test your turning radius in an empty parking lot. Turning too sharply could result in non-warranty damage to towing system, motorhome and/or towed vehicle.
- Do not back up with the towed vehicle attached or non-warranty damage will occur to your towing system, motorhome and/or towed vehicle.
- The safety cables must connect the towing vehicle to the towed vehicle frame to frame, with the cables crossed, with enough slack for sharp turns. Refer to the cable instructions for proper routing. Failure to leave enough slack in the safety cables, or failure to connect the safety cables frame to frame, will result in the loss of the towed vehicle.
- This bracket is designed for use with ROADMASTER tow bars and ROADMASTER adaptors only. Using this bracket with other brands, without an approved ROADMASTER adaptor, may result in non-warranty damage or injury.
- Upon final installation, the installer must inspect the bracket to ensure adequate clearance, particularly around hoses, air conditioner lines, radiators, etc., or non-warranty damage to the towed vehicle will result.
- This bracket is only warranted for the original installation. Installing a used bracket on another vehicle is not recommended and will void the warranty.

MOUNTING BRACKET KIT INSTALLATION INSTRUCTIONS

ROADMASTER, Inc. 6110 NE 127th Ave. Vancouver, WA 98682 1-800-669-9690 fax 360-735-9300 www.roadmasterinc.com

KIT NO. 1411-2

1. This bracket assembly fits between the frame and the front radiator support cross member, utilizing the frame weldnuts for attachment. *Note:* on vehicles with the Up-Country suspension package, the tow hooks and brackets attaching the tow hooks will have to be removed in order to mount the tow bar brackets. Also, re-secure backing plates inside frame by reinstalling at least 2 of the bolts previously removed with washers between the bolt head and the frame (to keep the backing plates from rattling while driving vehicle).
2. Locate and remove the two bolts securing the radiator cross member to the frame. Also remove the plastic splash guard retainer located 1½” behind the rear cross member bolt. This will expose a frame weld nut. *Note:* these bolts may have had Loctite applied and may require a breaker bar to loosen.
3. Unbolt the tubular cowl support from the radiator cross member and loosen the bolts that attach it to the cowl. These are located beneath the splash panel.
4. Insert a receiver brace through the lower bumper valance and insert it between the radiator cross member and the frame. Bolt with three 10mm x 1.5 x 40mm bolts and washers provided. Line up all three holes in the main frame and tighten the two forward holes.
5. Now, bolt a ¼” x 2” extension tab to the back of the radiator cross member (see illustration) using the existing bolt in the cross member. Bolt the loose end of the core support bracket to the tab using a 7/16” x 1½” bolt, washers and nut provided.
6. Now, follow the same procedure on the other side.
7. Reinstall the splash guard and torque the main frame bolts to the torque specifications below. Using the drawing on the first page as a reference, measure between the two front braces, ensuring that the distance is still 28” +/- ½”.
8. Insert the front braces into the receivers as illustrated and secure using the provided 5/8” draw pins and 1/8” spring pins. Recheck the measurements, to make certain this distance is still 28” +/- ½”.
9. Mount the tow bar according to the manufacturer’s instructions. *Note:* when towing, connect the tow vehicle’s safety cables to the bracket receivers using the provided quick links.

HARDWARE LIST:

- | | |
|---------------------------------------|--------------------------------------|
| 6-10MM X 1.5 X 40MM BOLTS | 2- 1/4"x 2"x 4-3/8" EXTENSION PLATES |
| 6-10MM FLAT WASHERS | 2- 7/16" FLAT WASHERS |
| 6-10MM LOCK WASHERS | |
| 2-7/16" NUTS | |
| 2-7/16" X 1½" BOLTS | |
| 2-7/16" LOCK WASHERS | |
| 2-1/8" SPRING PINS | |
| 2-5/8" DRAW PINS | |
| 2-QUICK LINKS | |
| 2- 13" SAFETY CABLES, 8,000 lb. rated | |

02-11-11

BOLT TORQUE REQUIREMENTS

Note: The torque values represented below are intended as general guidelines. Torque requirements for specific applications may vary. Roadmaster does not warrant this information to be accurate for all applications and disclaims all liability for any claims or damages which may result from its use.

STANDARD BOLTS			METRIC BOLTS			METRIC BOLTS		
Thread Size	Grade	Torque	Thread Size	Grade	Plated/Unplated	Thread Size	Grade	Plated/Unplated
5/16	5	13 ft./lb.	8mm-1.0	8.8	20 ft./lb. 18 ft./lb.	12mm-1.25	8.8	70 ft./lb. 65 ft./lb.
3/8	5	23 ft./lb.	8mm-1.25	8.8	19 ft./lb. 18 ft./lb.	12mm-1.5	8.8	66 ft./lb. 61 ft./lb.
7/16	5	37 ft./lb.	10mm-1.25	8.8	38 ft./lb. 36 ft./lb.	12mm-1.75	8.8	65 ft./lb. 60 ft./lb.
1/2	5	56 ft./lb.	10mm-1.5	8.8	37 ft./lb. 35 ft./lb.	14mm-2.0	8.8	104 ft./lb. 97 ft./lb.
5/8	5	150 ft./lb.						

All illustrations and specifications contained herein are based on the latest information available at the time of publication approval. ROADMASTER, INC. reserves the right to make changes at any time without notice in material, specification and models or to discontinue models.