

HYDRAULIC ASSIST DURA BIKE RACK INSTRUCTIONS



Model #26321

Important

This bike rack is designed for use in a 2" or 1.25" receiver and designed to hold a maximum of four bikes. Do not use this rack for anything other than carrying bicycles. Do not exceed your vehicle's receiver load ratings for any reason. This rack cannot be used on Class 1 vehicle receivers. Reference the instruction manual for proper use of this rack.

Warning

Check the tightness of bolts and nuts periodically as they may loosen slightly during normal use.

DO NOT drive the vehicle with the bike rack in the lowered position.

This rack CANNOT be mounted and used on the rear of trailers.

This rack MUST be removed from the vehicle before going through a car wash.

PARTS INCLUDED

- (A) Main rack assembly
- (B) Top plate
- (C) Bike rack arms (2)
- (D) Arm straps (12)
- (E) Carriage bolts and lock washers (4 each)
- (F) Hitch lock with keys
- (G) Hitch bolt with lock washer (5/8" for 2" rack, 1/2" for 1.25" rack)
- (H) 1.25" Hitch Bar

TOOLS REQUIRED

- 13mm socket with extension
- Adjustable wrench (2)
- Screw driver

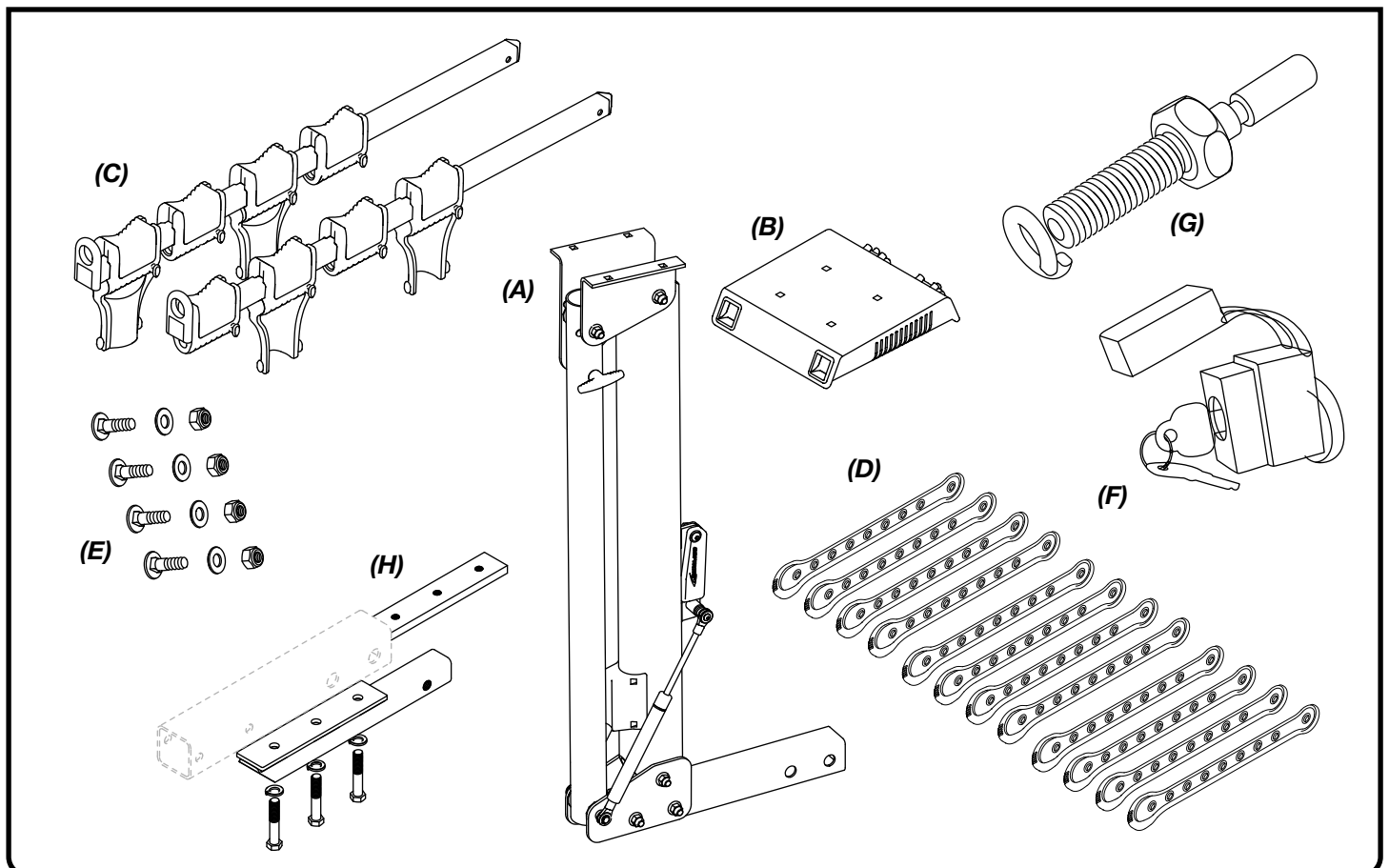

Assembly Of Rack

1

Begin assembly of rack by loading the carriage bolts into the 4 holes in the top plate. Place the top plate on the floor, top side down.

2

Position the main rack assembly on the top plate, aligning the mounting holes of the top plate with the holes in the brackets on the main assembly.

3

Be sure the cable lock can be accessed from the rear after the top plate has been secured. Place the lock washers and lock nuts on the carriage bolts and tighten them to 12 foot pounds.

4

To convert your 2" rack to a 1.25" rack you will need to add on the 1.25" assembly to the 2" hitch bar. Remove the nut holder from the inside of the 2" hitch bar assembly. Slide the three-holed nut plate **inside** the 2" hitch bar, aligning the holes. Pass the three bolts through the lock washer and 1.25" hitch bar and tighten to the nut plate. Make sure the three bolts are tightened securely and recheck the tightness of the bolts from time to time.

5

Place the straps on the bike arms.

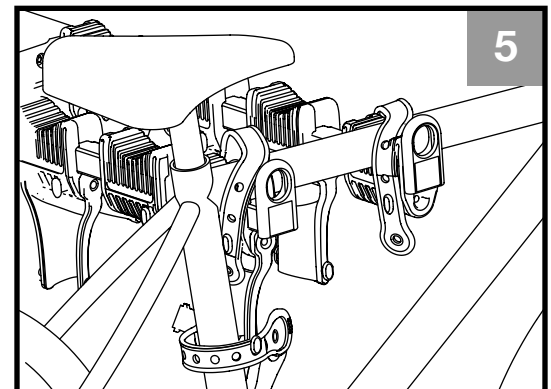
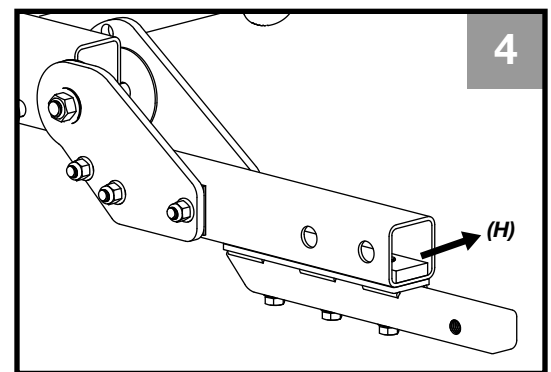
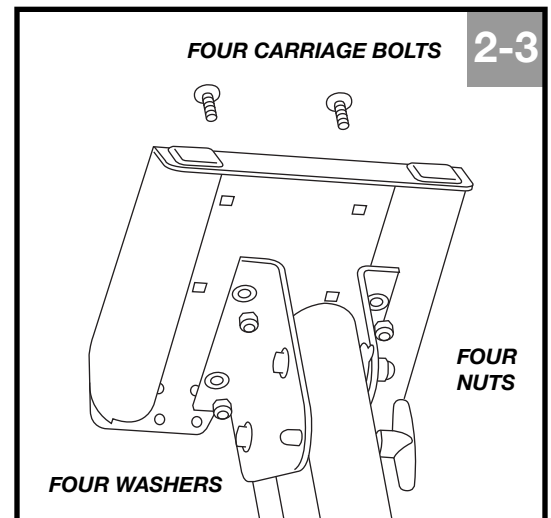
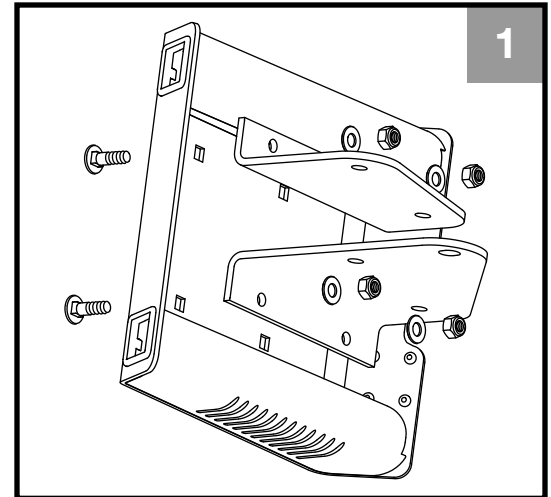

Installation Of The Rack

1

For 2" racks only. Check to make sure that the nut inside the rack hitch bar is aligned with the hole in the hitch bar. Adjust with a screw driver if necessary.

2

Slide the rack into the receiver hitch of the vehicle.

3

Line up the hole in the hitch bar with the hole in the receiver hitch.

4

Place the lock washer on the hitch bolt and thread it into the nut in the hitch bar. For 2" racks tighten the hitch bolt to 60 foot pounds. For the 1.25" rack, tighten the hitch bolt to 40 foot pounds.

5

To lock the bike rack to the vehicle, press the hitch lock over the bolt stud.

6

The bike arms must be oriented so that the inside curved surface of the anti-sway bracket is facing outward. Slide the arms into the top plate until you hear a click which indicates they have locked into the auto lock mechanism.

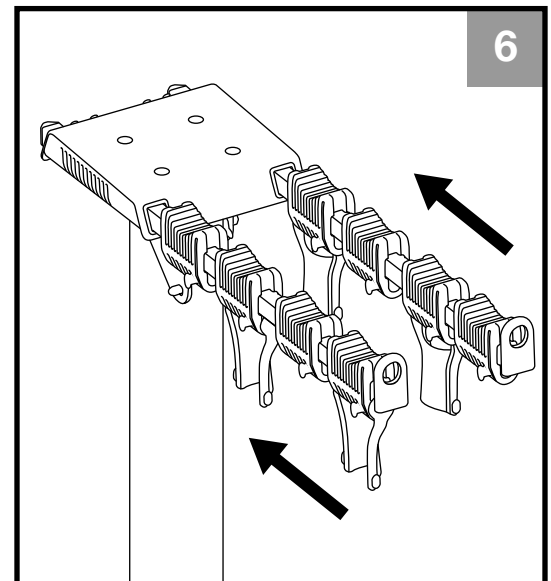
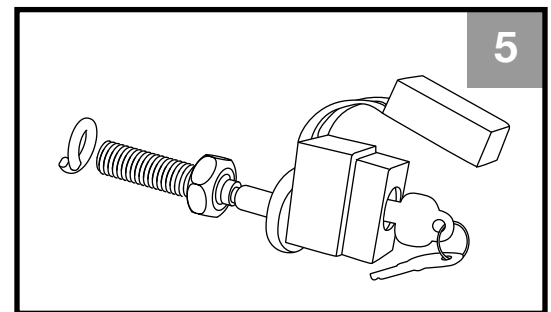
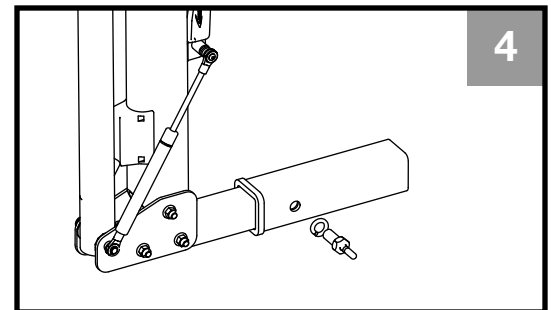
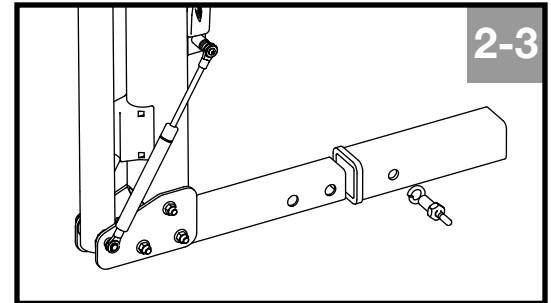

Use Of Rack

1

Place bicycles onto the rack starting at the point closest to the vehicle. Alternate the direction the bikes are facing when mounted on the rack. Some bike frames may require a “top tube” adapter to create flat mounting surface.

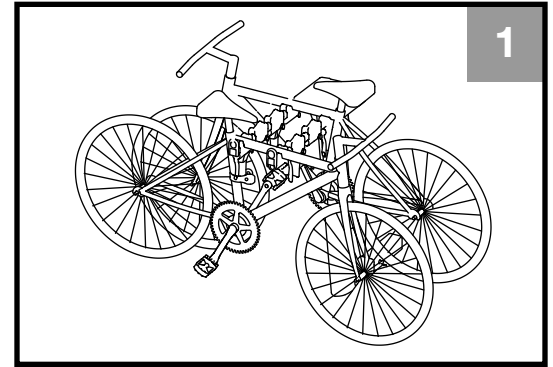

2

Position the seat post tube in the anti-sway cradle. Attach the bikes to the block and anti-sway mechanism using the straps provided. The bike may be off center on the rack. It is important that the anti-sway cradle is flush the bicycle seat tube. Avoid placing cable stops on blocks. Do not over tighten straps.

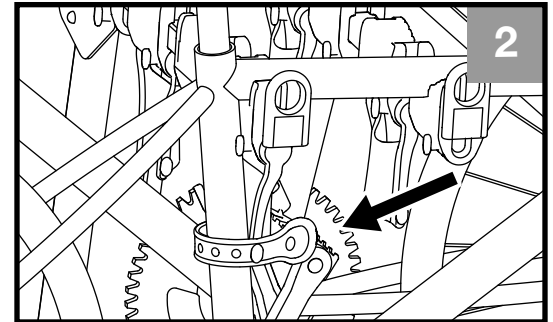

3

To utilize the cable lock, pull it out of the upright and along the side of the top plate, over the bicycle top tubes and attach it to the yellow bail on the end of one of the arms using a padlock.

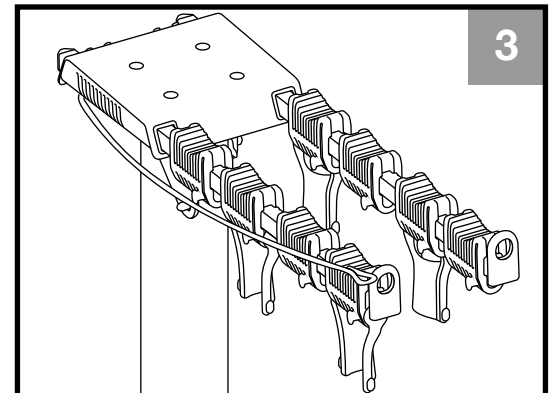

4

To lower the rack, grasp the release lever and while pushing the rack toward the vehicle pull the lever out. Supporting the arms of the rack, lower the unit.

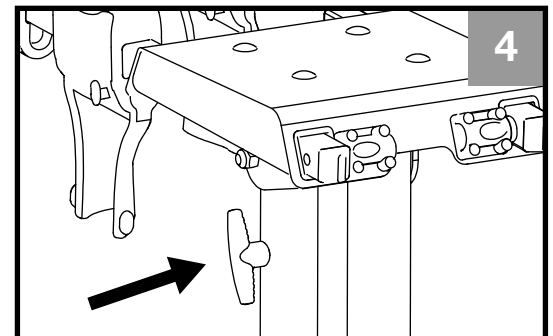

5

To raise the rack, push the arms of the rack up and toward the vehicle until you hear the pull pin click back into place.

6

When not carrying bikes, remove the arms and store.

Use Of Rack (cont.)

7

To remove the arms, press the release lever on the auto lock feature on the back of the top plate and pull the arm out.

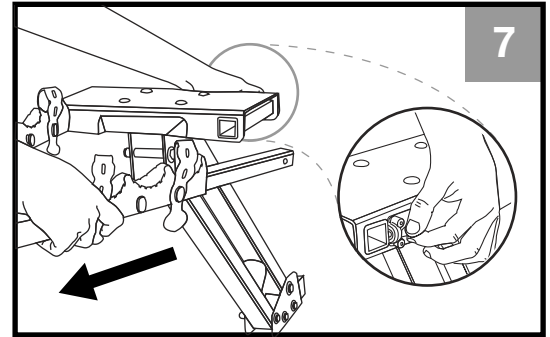

8

To use rack without hydraulic assist release lever on back of main upright. Always engage or disengage hydraulic release in upright position.

Questions? E-mail us at info@softride.com.

