



Ford Focus

Demco

BASEPLATE

Pin Height: 13" Centers: 17-3/4"

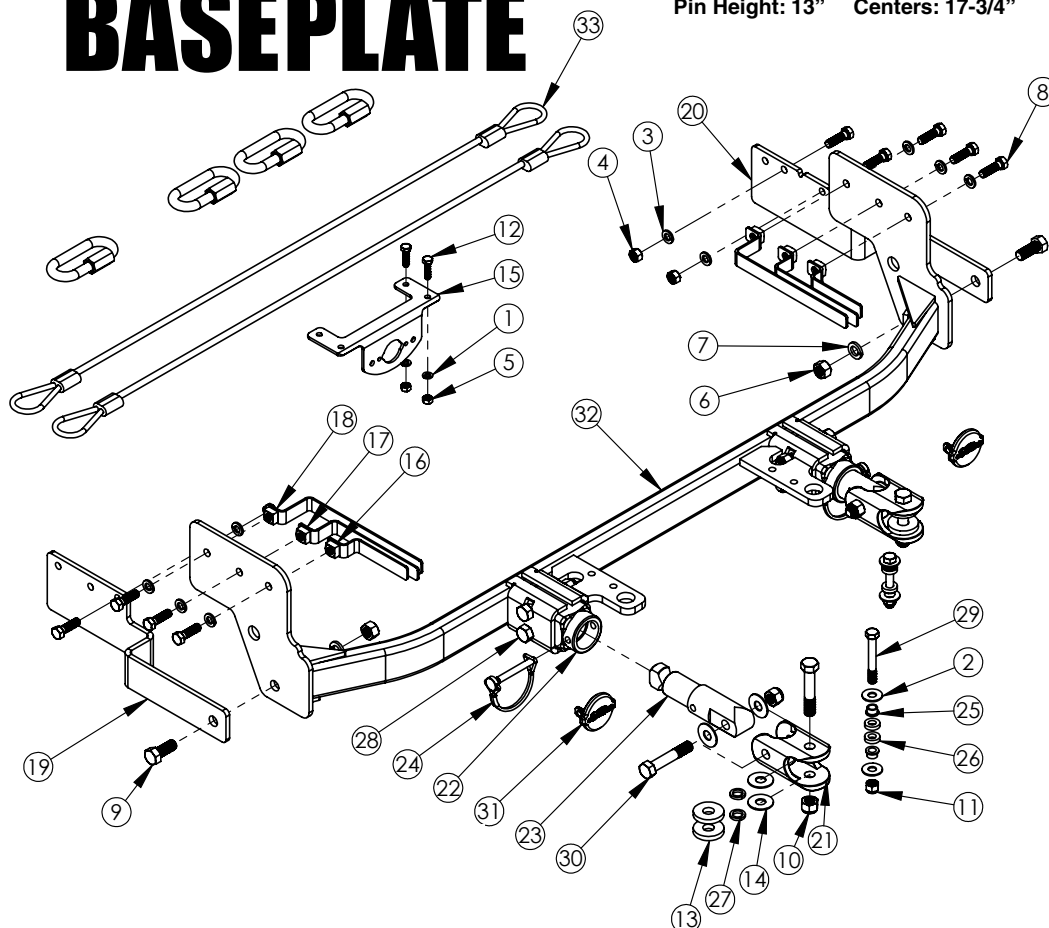

9519293 PARTS LIST

ITEM	PART #	QTY	DESCRIPTION
1	00057	2	WASHER, .25 SPRING LOCK
2	00059	4	WASHER, FLAT .375
3	00060	9	.375 LOCKWASHER
4	00061	3	.375 HEX NUT
5	00062	2	NUT .25NC HEX
6	00083	2	NUT, HEX, .50NC
7	00084	2	.50 LOCKWASHER
8	00523	9	BOLT, .375NC X 1.25 HEX HD GR.5
9	00967	2	BOLT, .50NC X 1.25
10	02178	8	NUT, .50NC LOCK, NY. INSERT
11	02592	2	NUT, .375NC NYLON LOCK
12	04055	2	.25-20NC X 1 GD5 HEX
13	07908-95	4	HEAVY WASHER
14	13317	8	CLEVIS SPACER WASHER
15	13612-76	1	PLUG MOUNT
16	14132	2	NUTSTRIP

Please order replacement parts by PART NO. and DESCRIPTION.

ITEM	PART #	QTY	DESCRIPTION
17	14133	2	NUTSTRIP
18	14134	2	BACK NUTSTRIP F/9518293
19	14135	1	SUPPORT BRACE
20	14136	1	SUPPORT BRACE
21	15040-81	2	END JOINT
22	15041-76	2	PULL BLOCK
23	15042-95	2	PULL STUD
24	15291	2	PN, 5/16" X 2.5 RD WIRE LOCK
25	15338	4	FLANGE BUSHING
26	15339	4	SPACER/WASHER NYLON
27	15340	4	SPACER/WASHER NYLON
28	15350	4	BOLT .50NC X 3.25 GR8 HEX
29	15351-95	2	BOLT .375 X 2.75 W/ 1.75 SHANK
30	15352-95	4	BOLT .50NC X 2.75 W/1.75 SHANK
31	15675	2	BASEPLATE PLUG COVER
32	15689	1	CROSSMEMBER F/ 9519293
33	6155	1	BASEPLATE SAFETY CABLE KIT

Please order replacement parts by PART NO. and DESCRIPTION.

ASSEMBLY
OPERATION
REPLACEMENT PARTS

READ complete manual CAREFULLY
BEFORE attempting operation.

Doing Our Best to Provide You the Best

OPERATORS MANUAL

WARNING: FAILURE TO FOLLOW THESE INSTRUCTIONS CAN RESULT IN LOSS OF TOWING VEHICLE CONTROL, SEPARATION OF THE TOW BAR FROM THE TOWING VEHICLE, SEPARATION OF THE TOWED VEHICLE FROM THE TOW BAR, CAUSING SEVERE PERSONAL INJURY, DEATH, OR PROPERTY DAMAGE.

WARRANTY POLICY, OPERATOR MANUALS & REGISTRATION

Go online to www.demco-products.com to review Demco warranty policies, operator manuals and register your Demco product.

CAUTION

Safety is of utmost importance at all times. There are several items that must be checked each time before using and while using a tow bar.

Before allowing anyone to hook up or operate a tow bar, be sure they have read and understand the proper operating procedure.

DO NOT use worn or damaged cables and/or pins.

Be sure the **SAFETY CABLES** are hooked, chassis to chassis, to both the towing and towed vehicles using the crisscross method.

Check clearance between vehicles in a turning situation.

Check base plate mounting bolts for tightness and frame for metal fatigue.

Do not load the towed vehicle with anything as you may exceed the towing capacity of the tow bar.

Keep fingers away from pivot points to prevent personal injury.

Be sure the steering components of the towed vehicle are properly aligned.

Demco baseplates are designed for use on factory vehicle suspension setups. Demco baseplates are not recommended for use on modified suspensions lowered or raised. Towing vehicle must be larger and at least 500 lbs. heavier than the towed vehicle and tow bar combined.

NOTE: This unit can be backed up in moderate increments. Any severe backwards cornering could result in damage to the Tow Bar and/or towed vehicle chassis.

For automatic transmissions: Consult your vehicle owners manual for towing suitability with the drive shaft connected. Otherwise, the towed vehicle will have to be equipped with a transmission pump or drive shaft disconnect.

Check to make sure that all lights are in proper working order.

The information on towability of vehicles is reprinted with permission of MotorHome® Magazine, and is believed to be reliable. However, Demco does not warrant the information to be correct. Always consult your towed vehicle owner's manual and follow towing instructions. Each year, MotorHome® Magazine, compiles a list of vehicles that can be towed four-down behind a motorhome with no modifications required.

 **Caution: MotorHome® Magazine** left out any vehicles that have towing speed limits slower than 55 m.p.h., or distance limits of less than 200 miles. At a minimum, these vehicles require significant modification, such as the use of an aftermarket product, to make them towable. The availability of a **Demco Tow Bar Base Plate** does **not** imply that these vehicles can be modified or that there is an aftermarket product available. Refer to your vehicle owner's manual or consult your dealer to determine whether your vehicle can be modified to make it towable. Failure to observe this precaution could result in property damage or personal injury.

IMPORTANT INSTALLATION ITEMS

DEMCO products and accessories are intended to be installed by professional installers with experience, proper equipment and the ability to do modification work. Installers with these qualifications can be found in RV and Automotive Service Centers.

If the car to be towed has been in an accident, the chassis may be damaged in an area where the Base Plate attaches. It may no longer be suitable for towing. Extreme caution and careful examination are required in such a situation. It is also likely, even from a minor accident, that the hole alignment will be more difficult due to hole alignment problems.

Many DEMCO Base Plates are designed to use existing holes and hardware to mount the Base Plate to the towed vehicle. Even though the bolt is there, however, do not assume it is adequate for mounting the Base Plate. Manufacturers make many changes in hardware both within and between model years. Be sure the bolt is long enough to protrude past the nut a distance no less than 1/2 the diameter of the bolt, after the Base Plate is mounted. The threads should be in good condition. **We require that "LOCTITE® Blue" be used on all bolts.** If a new bolt is required, be sure it is SAE Grade 5 or Metric 8.8.

NOTE: The dimensional variations between otherwise identical vehicles can be considerable. Some minor modifications may have to be made to ensure a proper fit.

BOLT TORQUE SPECIFICATIONS					
STANDARD BOLTS:			METRIC BOLTS:		
Size	Grade	Torque	Size	Grade	Torque
5/16"	5	18 ft/lbs	8mm	8	23 ft/lbs
3/8"	5	30 ft/lbs	10mm	8	45 ft/lbs
7/16"	5	50 ft/lbs	12mm	8	78 ft/lbs
1/2"	5	75 ft/lbs	14mm	8	125 ft/lbs

INSTALLATION INSTRUCTIONS



1. Remove four plastic push fasteners and two Torx screws from top of fascia.

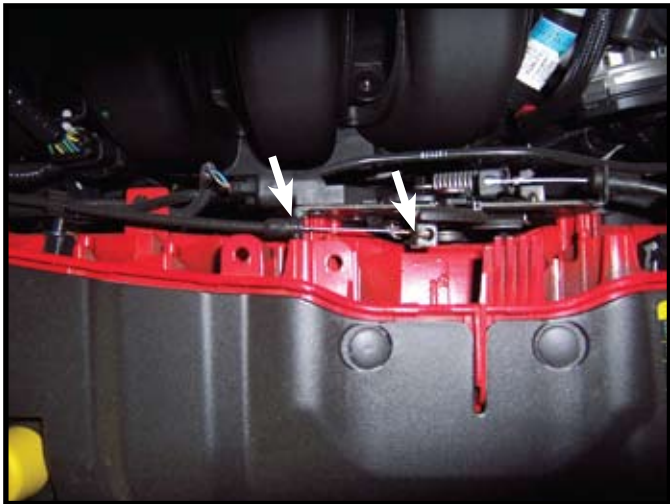

2. Remove hood release cable from brackets.



3. Remove two screws and one plastic push fastener from each wheel well.



4. Remove six plastic push fasteners from bottom of fascia.



5. Remove two screws from each headlight housing and set aside.



6. Remove fascia by pulling out on fascia by the fender, then release clips as shown in picture on each side. Unplug fog light master connection on drivers side if equipped. Pull fascia forward and set aside.



7. Remove two screws from top and three tabs from bottom of air deflector and remove air deflector.



10. Remove two screws from washer tank. Unplug two electrical fittings. Disconnect washer hoses and cap. Slide tank back and set aside.

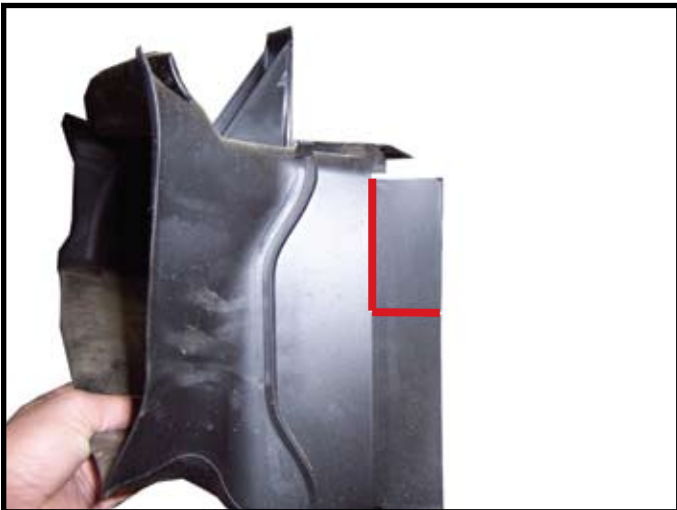

8. Trim air deflector as shown in picture. Repeat on other side of air deflector.

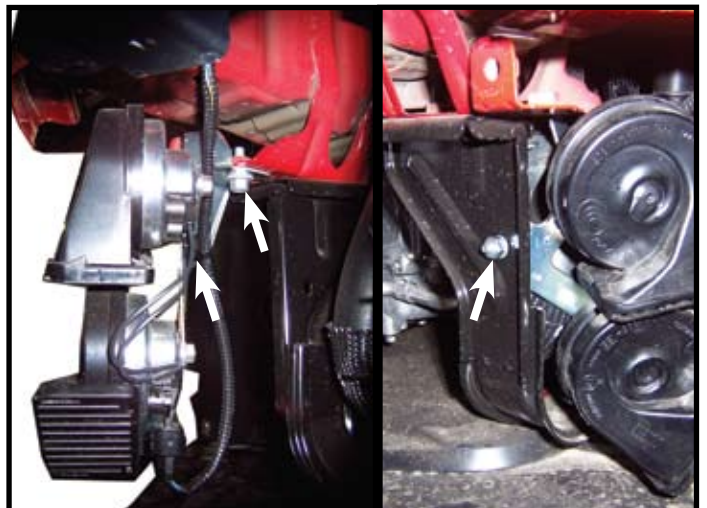

11. Remove one bolt and wire fastener from horn bracket as shown in picture on the left. Relocate horn with 1/4" x 3/4" bolt, 1/4" lock washer, and 1/4" nut as shown in picture on the right.

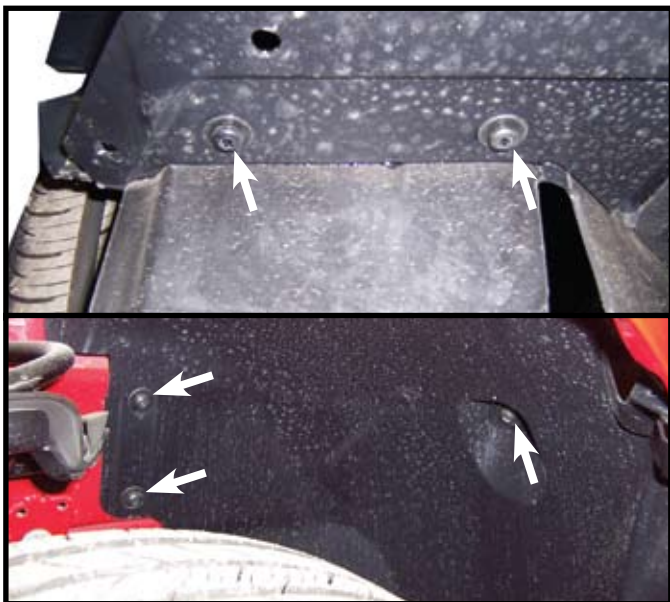

9. Remove two screws from bottom of front wheel well on each side as shown in top picture. Remove three screws from each wheel well as shown in bottom picture.



12. Remove three screws from computer box on drivers side and slide down out of the way.

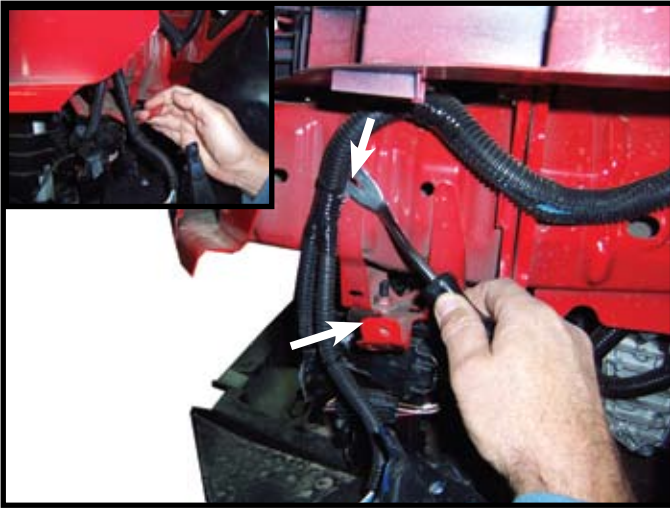

13. Remove one wire from frame and one wire from computer box bracket. Using two hands pull down computer box bracket down for clearance for baseplate install as shown in picture.



14. Drill hole in bumper on each side using a 1-3/4" or 2" bi-metal holesaw as shown in picture. **NOTE:** May want to start out by drilling a 1/4" hole as shown in upper left picture. Try and center hole in center of frame opening.

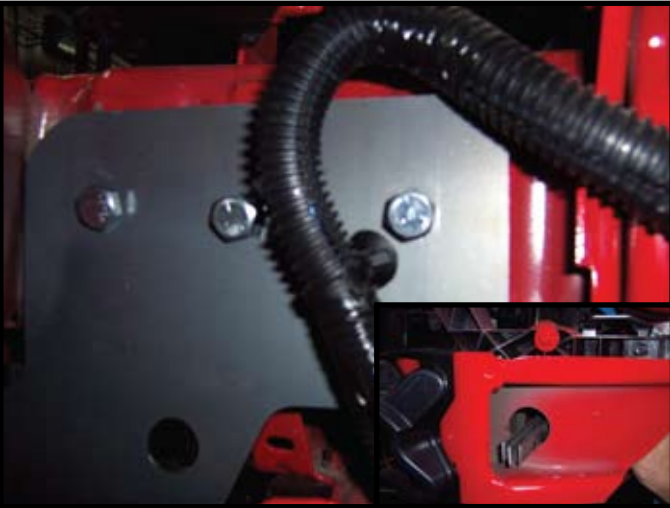

15. Slide baseplate on to frame from bottom and insert 3/8" x 1-1/4" bolts with 3/8" lock washers and nutstrips. Start with rear nutstrip and go forward. Leave bolts loose till later. **NOTE:** Use **LOCTITE** on all bolts and nuts.

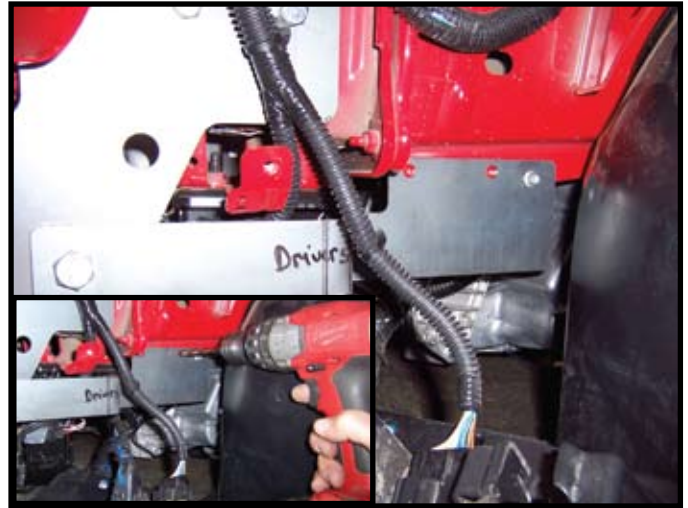

16. **Drivers Side** Put computer box bolt in back hole to brace and 1/2" x 1-1/4" bolt, 1/2" lock washer, and 1/2" nut in front hole of brace and bottom hole of baseplate. Push up on brace and tighten both bolts. Use a 3/8" drill bit to drill the two open holes in bracket using the bracket as a jig. Insert 3/8" x 1-1/4" bolts, 3/8" lock washer, and 3/8" nut in drilled holes and tighten. Remove back bolt for later installation with computer box. Tighten bolts according to torque chart on front page.

Note: Use **LOCTITE** on all bolts and nuts.



17. **Passenger Side** Put the two washer tank bolts in the back holes of the brace and 1/2" x 1-1/4" bolt, 1/2" lock washer, and 1/2" nut in front hole of brace and bottom hole of baseplate. Tighten all three bolts. Use a 3/8" drill bit to drill the open hole in bracket using the bracket as a jig. Insert 3/8" x 1-1/4" bolt, 3/8" lock washer, and 3/8" nut in drilled hole and tighten. Remove back bolt for later installation with washer tank. Tighten bolts according to torque chart on front page.

Note: Use **LOCTITE** on all bolts and nuts.

18. Tighten the six bolts holding the baseplate to the frame. Tighten bolts according to torque chart on front page.



19. Reinstall washer tank using 8MM 1.25 x 40MM bolts with 8MM lock washers and 8MM fender washers. When putting in back bolt put 7/16" nut between washer tank and bracket as shown in bottom picture.



20. Bend computer box bracket up and using the original screws reinstall the computer box.

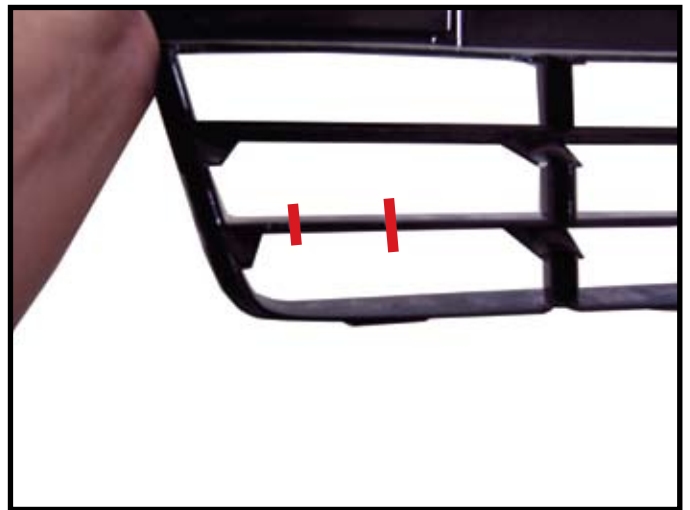

21. Trim the lower air dam on red lines to allow pullears to pass through. Trim any extra as you see fit.



22. Reinstall fascia and headlights in reverse order. Plug mount (item #15) may be installed if desired in convenience holes on either chain anchor or as desired.

INSTRUCTIONS FOR TOWED VEHICLE BASEPLATE SAFETY CABLES & PARTS BREAKDOWN

Example #1

Wrap the safety cable around the baseplate crossmember and attach with one quick-link. Attach the other end of the safety cable to the vehicles frame rail or crossmember of the vehicles frame using another quicklink. **See illustration below. NOTE:** when routing cable, make sure cable does not touch or rub against wires, brake hoses, brake lines or axle shafts. Do this on each side of the baseplate.

Baseplate pictured is for illustration only and is not your specific baseplate.

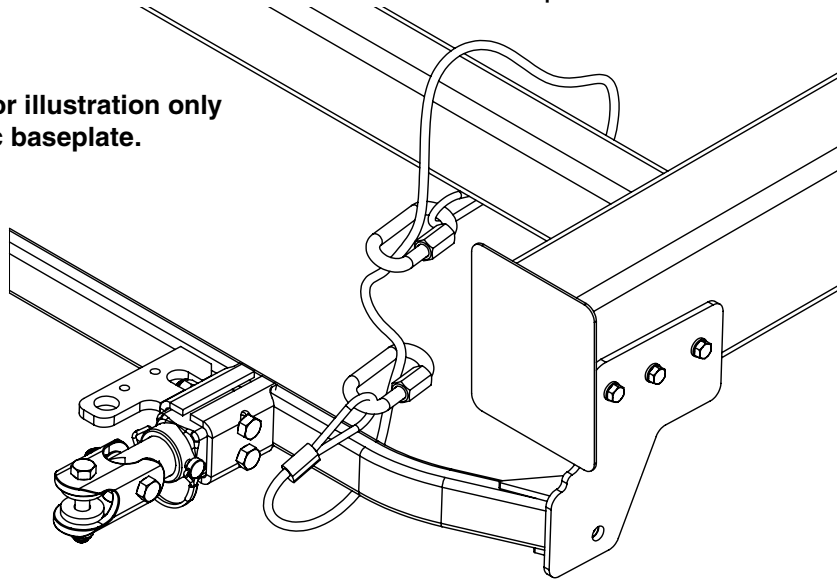

Example #2

Some baseplate models have a hole to mount the quicklink and cable. Example: some baseplates may not have a crossmember from one side to the other, thus you have a quicklink mounting hole. **See illustration below:** this shows the use of just one quick-link. Other installs may require 2 quicklinks depending on baseplate model. **NOTE:** when routing cable, make sure cable does not touch or rub against wires, brake hoses, brake lines or axle shafts. Do this on each side of the baseplate.

Baseplate pictured is for illustration only and is not your specific baseplate.

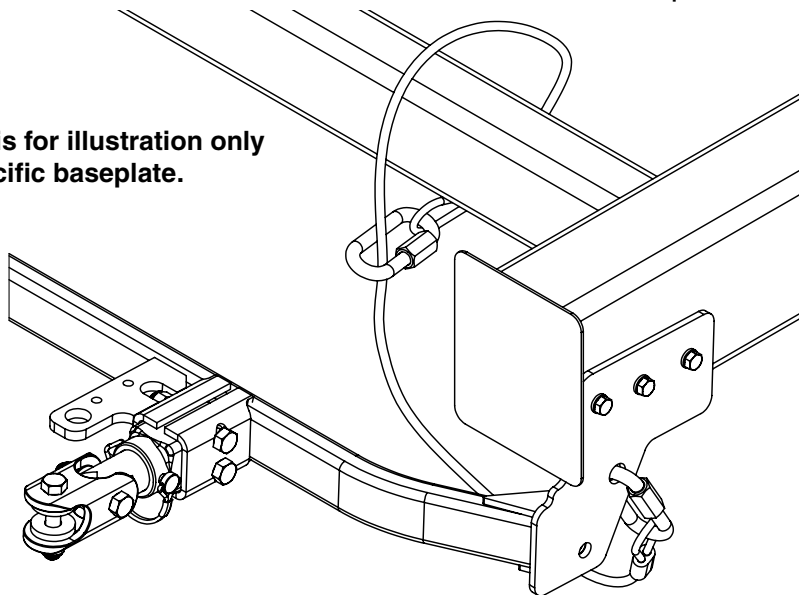

REF. NO.	PART NO.	QTY.	DESCRIPTION
-	6155	-	Safety Cable Kit
1.	-	2	36" Nylon coated safety cables rated @ 14,000 lbs. per pair
2.	-	4	1/2" Quicklinks rated @ 10,000 lbs. each

Installation to Tow Bar

Demco Commander Tow Bar



Hardware Used: two 3/8" bolts, four 3/8" steel washers, four 3/8" poly washers, four 3/8" poly bushing and two 3/8" lock nuts.

1. Remove existing clevis from end of tow bar shaft.
2. Install poly bushing from inside clevis using a pliers to squeeze bushing into hole. You can use a rag or cardboard between pliers to protect bushing and clevis from damage. If bushing is hard to start in hole, hole may be cleaned out with 1/2" drill bit.
3. The 3/8" poly washers go in between the tow bar shaft and poly bushings.
4. The 3/8" steel washers go on the outside of clevis fastened by the 3/8" bolt and nut.
5. Tighten nut snug so you can still rotate clevis on tow bar shaft.

Demco Excalibar II Tow Bar



Hardware Used: two 1/2" bolts, four 1/2" narrow rim poly washers and two 1/2" lock nuts

1. Remove existing clevis from end of tow bar shaft.
2. Install the 1/2" narrow rim poly washers between the tow bar shaft and clevis.
3. Tighten nut snug so you can still rotate clevis on tow bar shaft.

Demco Dominator Tow Bar



Hardware Used: two 1/2" bolts, four 1/2" wide rim poly washers and two 1/2" lock nuts

1. Remove existing clevis from end of tow bar shaft.
2. Install the 1/2" wide rim poly washers between the tow bar shaft and clevis.
3. Tighten nut snug so you can still rotate clevis on tow bar shaft.

Demco Excalibar or Aluminator Tow Bar



Hardware Used: two 1/2" bolts and two 1/2" lock nuts

1. Remove existing clevis from end of tow bar shaft.
2. Install tow bar shaft into clevis.
3. Tighten nut snug so you can still rotate clevis on tow bar shaft.

Roadmaster Tow Bars



Hardware Used: two 1/2" bolts and two 1/2" lock nuts or two 1/2" bolts, four 1/2" - 1/4" thick washers and four 1/2" wide rim poly washers and two 1/2" lock nuts

1. Remove existing clevis from end of tow bar shaft.
2. If you tow bar came with a black bushing or red ends, install end into clevis and fasten using the provided 1/2" bolts and tighten nut snug so you can still rotate clevis on tow bar shaft.
3. If you have a Sterling towbar without the black bushing, install clevis using the 1/4" thick washers and 1/2" wide rim poly washers as shown in bottom picture.

Hooking Up Tow Bar to Baseplate

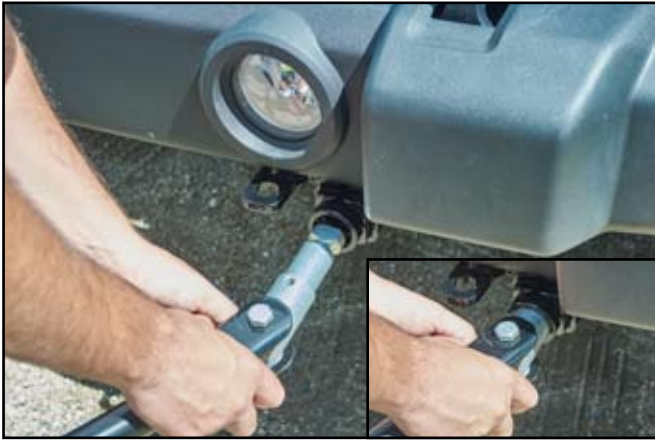

1. Insert pull tab into baseplate pull socket with the flat spot and locking hole facing up. Push pull tab into socket until it stops.



2. Rotate assembly 90° until lock pin holes line up. (Tab to clevis bolt will be horizontal while tow bar to clevis bolt will be vertical).



3. Insert locking pin into cross hole. If pin does not install, pull tab may not be installed correctly or try rotating tab 180° and try again. Hook up safety cables and other equipment required for towing your vehicle

Unhooking Tow Bar from Baseplate

1. Release the pressure from tow bar as stated in your tow bar manual.
2. Reverse the hooking up process.

Plug Cover Instructions

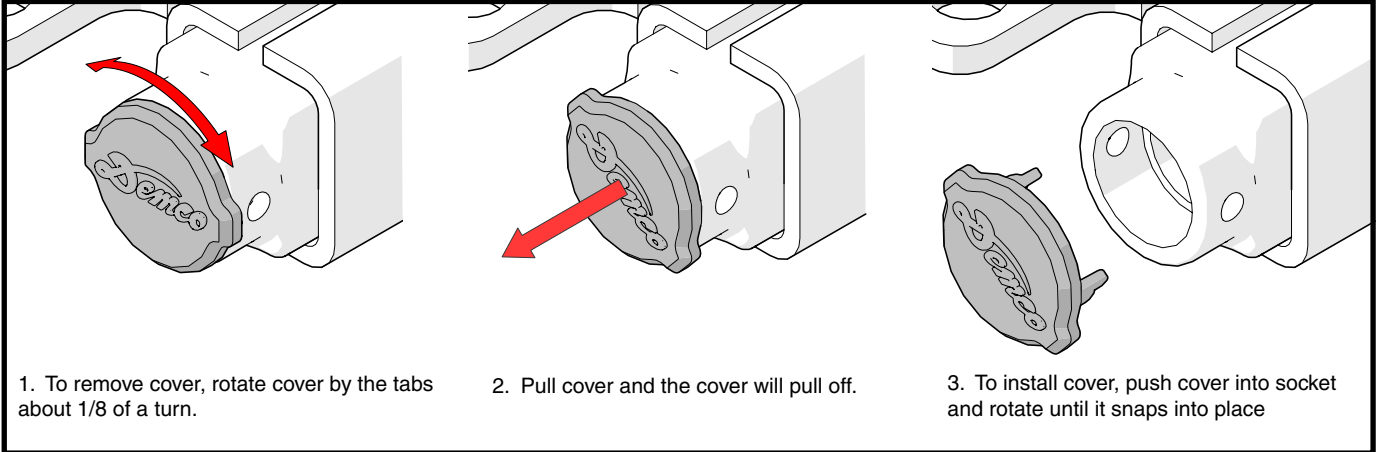

NOTES

Demco

4010 320th St., BOYDEN, IA. 51234

PH: (712) 725-2311

FAX: (712) 725-2380

TOLL FREE: 1-800-54DEMCO (1-800-543-3626)

www.demco-products.com

Go online to www.demco-products.com for Demco warranty policies, operator manuals & product registration.