



## BX88133 Installation Instructions BlueOx Baseplate Adapter

1. Slide receiver connector (2) into the attachment tabs extending out from the vehicle.
2. Line up the large 1/2 inch holes and insert pins.
3. Place the retaining plate (6) on the top and bottom of the 1/2 threaded rod on the receiver connector.
4. Secure the plates with 1/2 hex nut and lock washer.
5. Center the cross angle (1) on the top plate of the receiver connectors and secure with 1/2 inch bolts, lock washers, and hex nuts.
6. Install the tow bar and safety cables according to the instructions included in their packages.
7. DEALER OR INSTALLER: BE CERTAIN THE USER RECEIVES THE INSTRUCTION SHEET.

### Parts List

Ref. No.	Qty.	Part No.	Description
1	1	61-5361 .....	Cross Angle
2	2	61-5360 .....	Receiver Connector
3	4	201-0011 .....	1/2-13 X 1 1/4 Hex Bolt
4	8	203-0012 .....	1/2 Lock Washer
5	8	202-0005 .....	1/2-13 Hex Nut
6	4	102-5781 .....	Retaining Plate
7	4	203-0005 .....	1/2 Flat Washer
E		XXXXXX .....	Blue Ox Baseplate

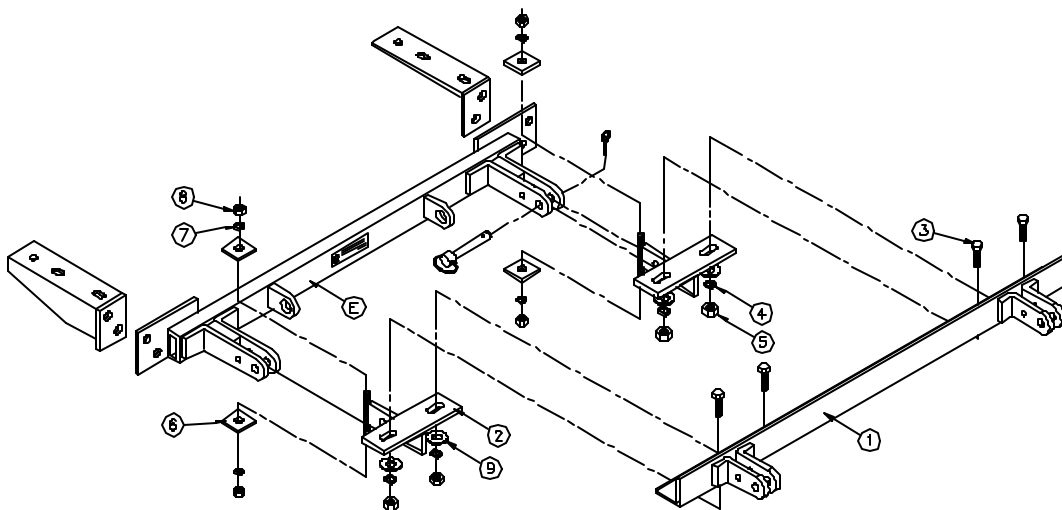

# Automatic