

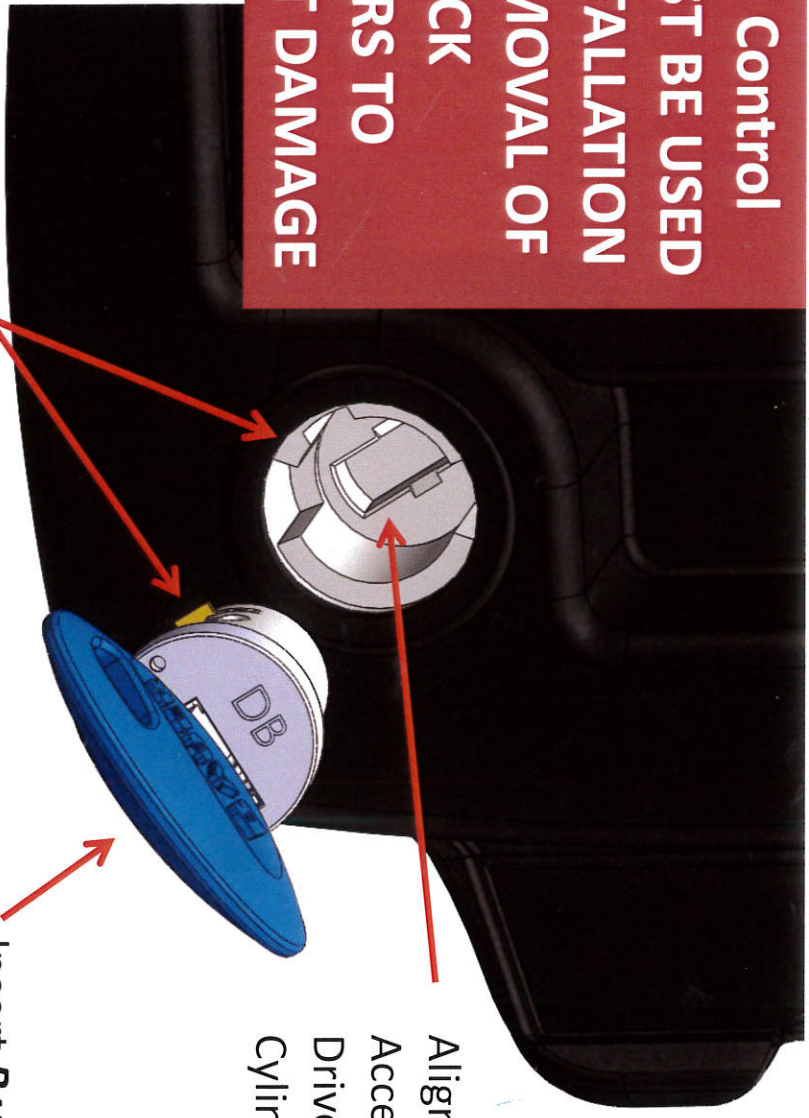

# Bauer Products

## BAUER RV Dead Bolt Lock Cylinder Insertion Step 1

**BAUER RV Control  
Key MUST BE USED  
FOR INSTALLATION  
AND REMOVAL OF  
BAUER LOCK  
CYLINDERS TO  
PREVENT DAMAGE**



Align Brass Keeper  
Tab with Angled Slot  
in Lock Core

Align Clutch Slot to  
Accept Rectangular  
Drivers on DB Lock  
Cylinder

Insert **BAUER RV Control**  
Key into DB Lock  
Cylinder as shown

# *BAUER RV Dead Bolt Lock Cylinder Insertion Step 2*



Insert **BAUER** RV DB Lock Cylinder into Lock Core as shown. Lock Cylinder will go all the way in if alignment is correct.

# Bauer Products

## BAUER RV Dead Bolt Lock Cylinder Insertion Step 3



Rotate **BAUER** RV DB Lock  
Cylinder Counter  
Clockwise Until Key Slot  
is in Vertical Position as  
shown and remove  
**BAUER** RV Control Key

# Bauer Products

## BAUER RV Paddle Lock Cylinder Insertion Step 1

**BAUER RV Control  
Key MUST BE USED  
FOR INSTALLATION  
AND REMOVAL OF  
BAUER LOCK  
CYLINDERS TO  
PREVENT DAMAGE**

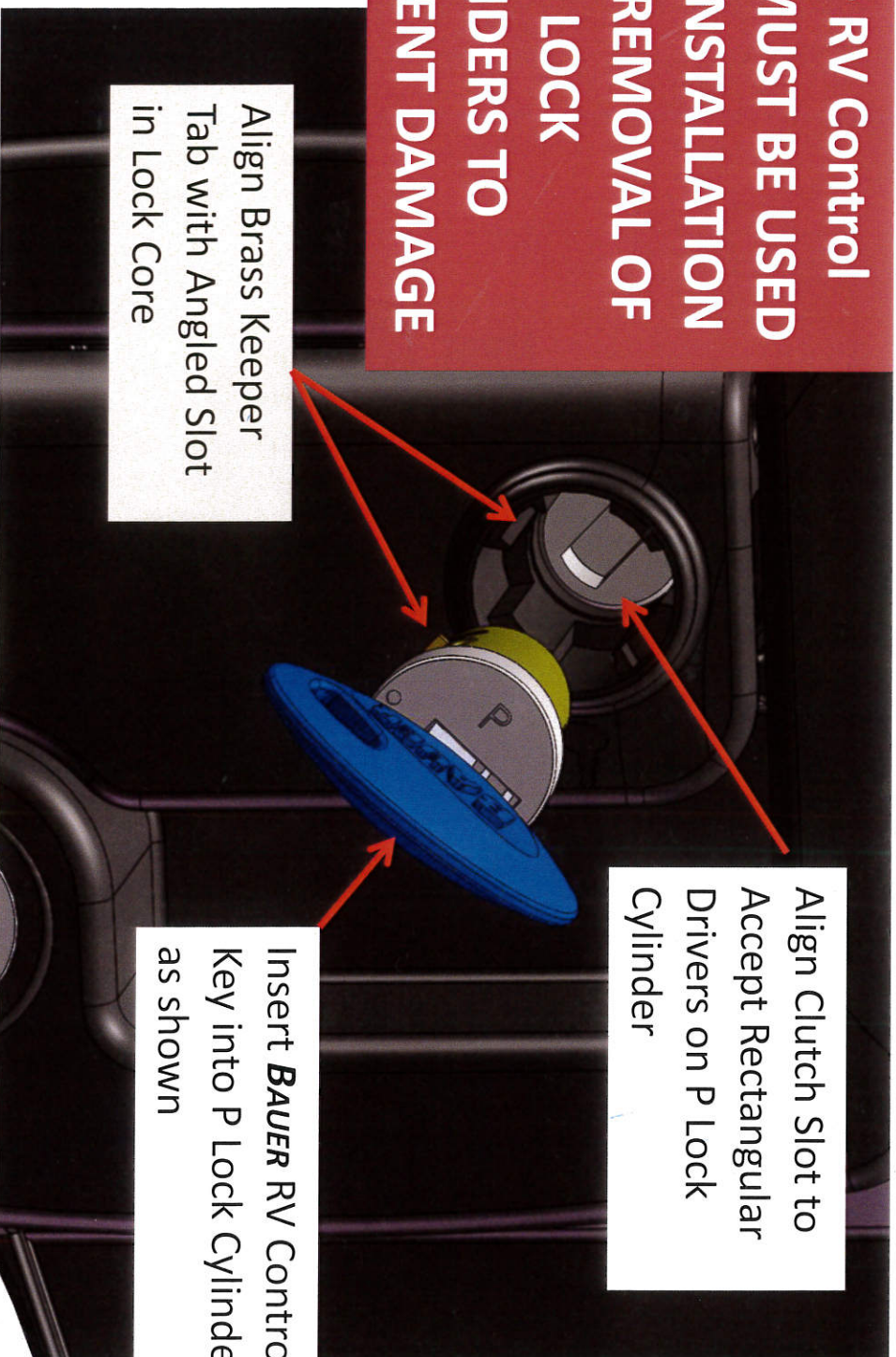

Align Brass Keeper  
Tab with Angled Slot  
in Lock Core

Align Clutch Slot to  
Accept Rectangular  
Drivers on P Lock  
Cylinder

Insert **BAUER RV Control**  
Key into P Lock Cylinder  
as shown

# Bauer Products

## BAUER RV Paddle Lock Cylinder Insertion Step 2

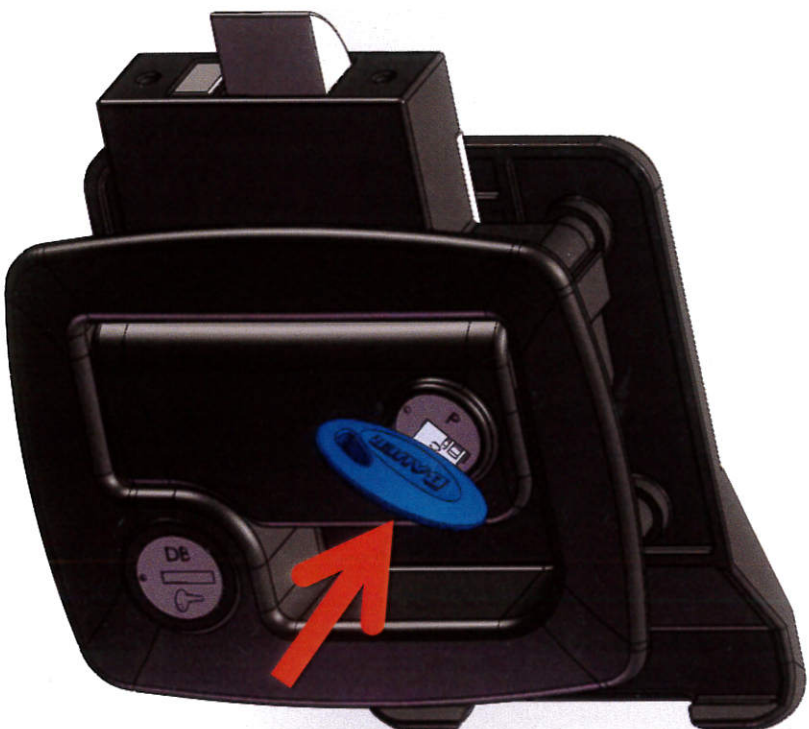

Insert **BAUER RV P Lock** Cylinder into Lock Core as shown. Lock Cylinder will go all the way in if alignment is correct.

# Bauer Products

## BAUER RV Paddle Lock Cylinder Insertion Step 3

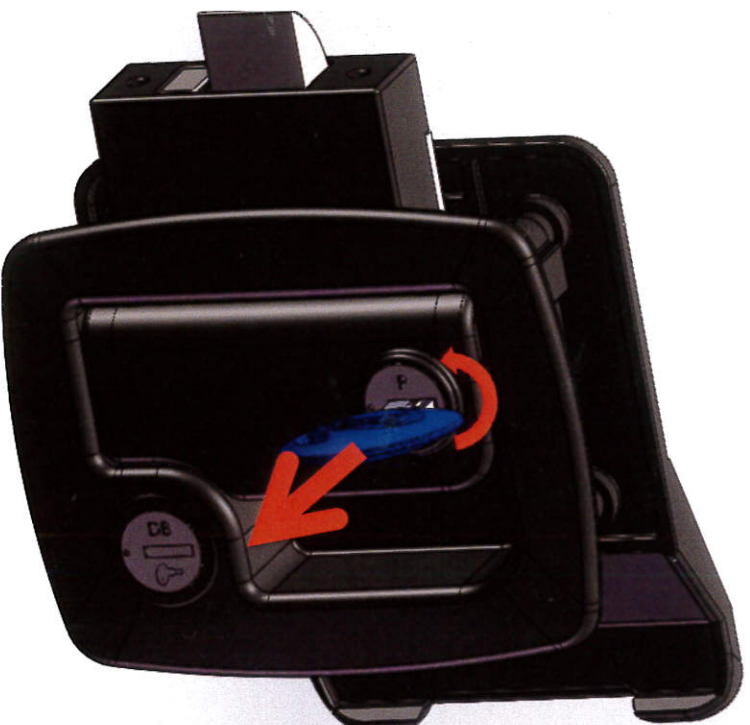

Rotate **BAUER RV P Lock**  
Cylinder Counter  
Clockwise Until Key Slot  
is in Vertical Position as  
shown and remove  
**BAUER RV Control Key**