



RECORD THIS INFORMATION FOR FUTURE
REFERENCE:

Model Number _____
Serial Number _____
Date Purchased _____
Retailer / Qualified Installer _____

INSTALLATION INSTRUCTIONS

MILENCO® SECURITY DOOR LOCK

DM-4718

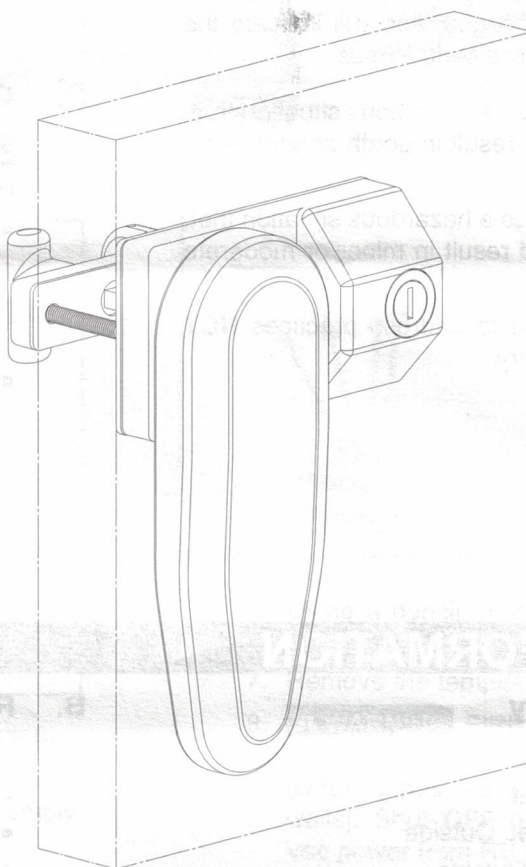

**Read these instructions carefully. These
instructions MUST stay with this product.**

Form No. 3316448.000 10/15
©2015 Dometic Corporation
LaGrange, IN 46761

USA
SERVICE OFFICE
Dometic Corporation
2320 Industrial Parkway
Elkhart, IN 46516

CANADA
Dometic Corporation
46 Zatonski, Unit 3
Brantford, ON N3T 5L8
CANADA

**SERVICE CENTER &
DEALER LOCATIONS**
Please Visit:
www.eDometic.com

DOCUMENT SYMBOLS



Indicates additional information that is **NOT** related to physical injury.



Indicates step-by-step instructions.

IMPORTANT SAFETY INFORMATION

This manual has safety information and instructions to help you eliminate or reduce the risk of accidents and injuries.

A. Recognize Safety Information



This is the safety alert symbol. It is used to alert you to potential physical injury hazards. Obey all safety messages that follow this symbol to avoid possible injury or death.

B. Understand Signal Words

A signal word will identify safety messages and property damage messages, and will indicate the degree or level of hazard seriousness.

⚠ WARNING indicates a hazardous situation that, if **NOT** avoided, could result in death or serious injury.

⚠ CAUTION indicates a hazardous situation that, if **NOT** avoided, could result in minor or moderate injury.

NOTICE is used to address practices **NOT** related to physical injury.

C. Supplemental Directives



Read and follow all safety information and instructions to avoid possible injury or death.

Read and understand these instructions before [installing / using / servicing / performing maintenance on] this product.

Incorrect [installation / operation / servicing / maintaining] of this product can lead to serious injury. Follow all instructions.

The installation **MUST** comply with all applicable local and national codes.

D. General Safety Messages

⚠ WARNING Failure to obey the following warnings could result in death or serious injury:

- This product **MUST** be [installed / serviced] by a qualified service technician.
- Do **NOT** modify this product in any way. Modification can be extremely hazardous.
- The security door lock **MUST** be mounted to an RV wall in a location without obstacles (wires, pipes, etc.). It is the responsibility of the installer to contact the RV dealer or manufacturer to obtain wire and pipe locations.

GENERAL INFORMATION

A. Scope Of Delivery

- (1) Inside Lock Unit
- (1) Outside Lock Unit
- (1) Horizontal Gasket, Outside
- (1) Vertical Gasket, Outside
- (1) Inside Gasket
- (1) Template
- (1) Screw (M6 - 1 x 46 mm)
- (1) Screw (M6 - 1 x 56 mm)
- (2) Plug
- (3) Key

B. Required Tools

- Pencil
- Power Drill
- 1/4" Drill Bit
- 1/2" Drill Bit
- #3 Phillips screwdriver
- Sealant

C. RV Requirements

DM-4718 security door lock is designed for RVs with wall thickness of 1-1/4" to 1-3/8" (32 - 35 mm). For wall thickness other than those listed, installer must acquire suitable length mounting screws.

INSTALLATION

1. Plan and determine location to mount door lock, considering available space, both inside and outside, as well as position of accessories, such as fly screens, etc.

i Security door lock can be mounted on either a left-hand or right-hand door. See (FIG. 1).

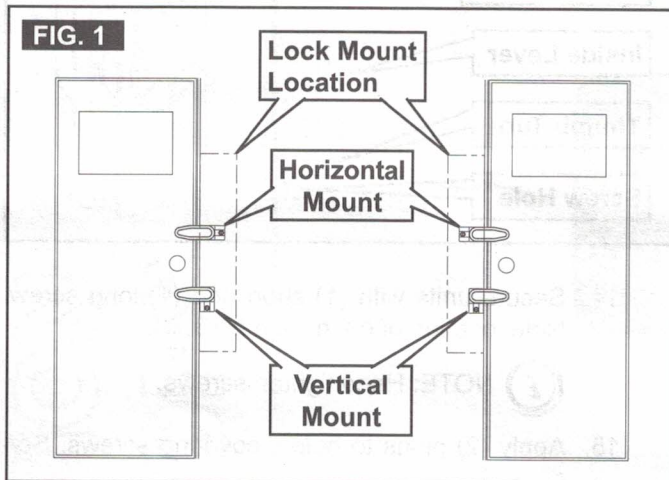

2. Determine whether lock will be mounted horizontally or vertically. See (FIG. 1) and (FIG. 2).

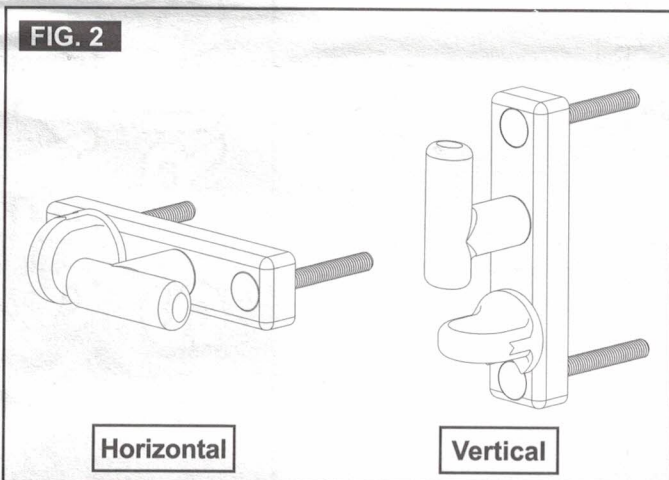

3. Select the correct horizontal or vertical 2-3/4" x 4-13/16" gasket. NOTE: The arrow cut-outs of the gasket are to point upward upon assembly. See (FIG. 3).

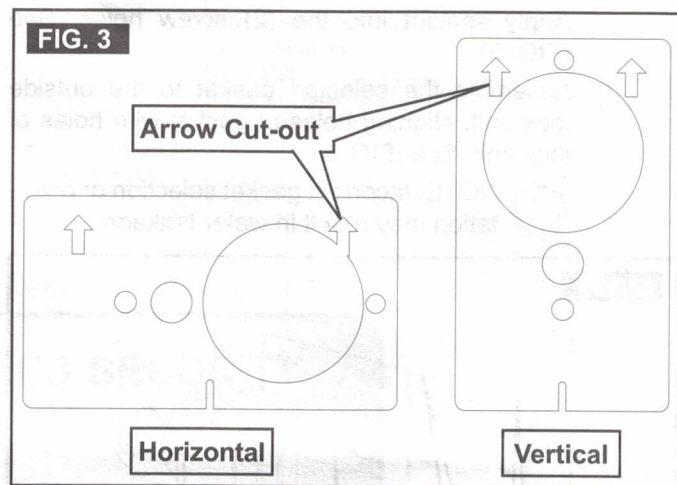

4. Align hole cut-outs of template with holes of gasket, noting arrow direction (upward).
5. Remove sticky-back template from paper backing and apply to pre-determined mount location on outside of RV wall. See (FIG. 4).

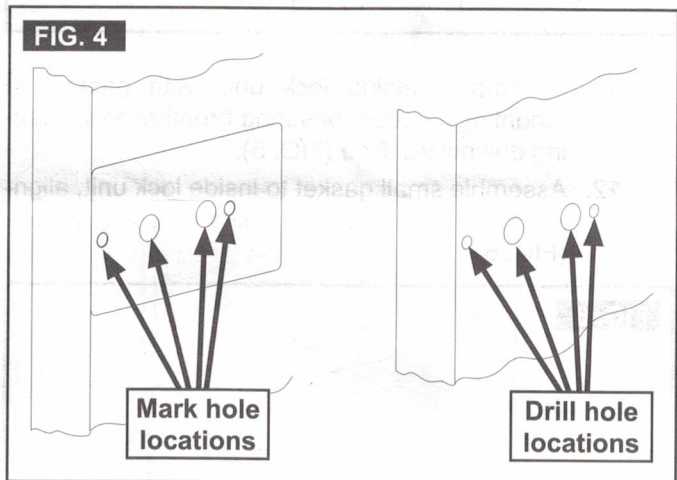

6. Using a pencil, mark the (4) holes of the template. See (FIG. 4).
7. Remove the template.
8. **⚠ WARNING FIRE OR ELECTRICAL SHOCK HAZARD.** Make sure there are no obstacles (wires, pipes, etc.) inside RV's [roof / floor / walls]. Shut **OFF** gas supply, disconnect 120 Vac power from RV, and disconnect positive (+) 12 Vdc terminal from supply battery **BEFORE** drilling or cutting into RV. Failure to obey these warnings could result in death or serious injury. Drill (2) 1/2" diameter holes and (2) 1/4" diameter through holes as marked. See (FIG. 4).
9. **NOTICE ALWAYS** use sealant on (clean) parts and surfaces where fasteners enter RV's [walls / roof / floor]. Otherwise, water leakage could occur.

INSTALLATION

Apply sealant into the (2) screw holes. See (FIG. 5).

10. Assemble the selected gasket to the outside lock unit, aligning holes of gasket with holes of lock unit. See (FIG. 5).

(i) NOTE: Incorrect gasket selection or orientation may result in water leakage.

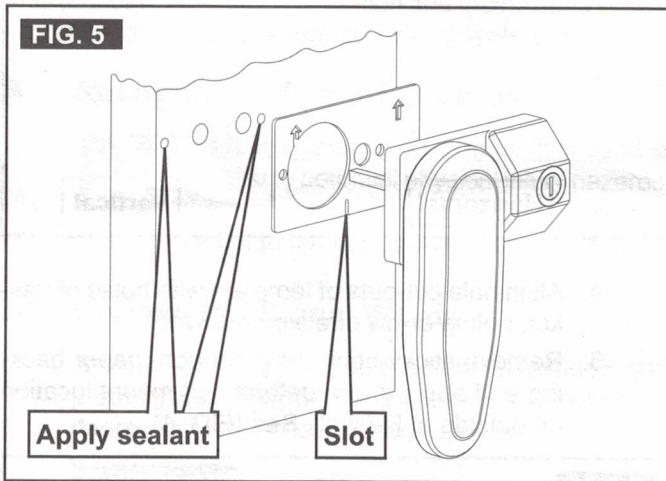

11. Assemble outside lock unit, with gasket, to mounting location, ensuring breather slot is facing downward. See (FIG. 5).
12. Assemble small gasket to inside lock unit, aligning holes of gasket with holes of lock unit. See (FIG. 6).

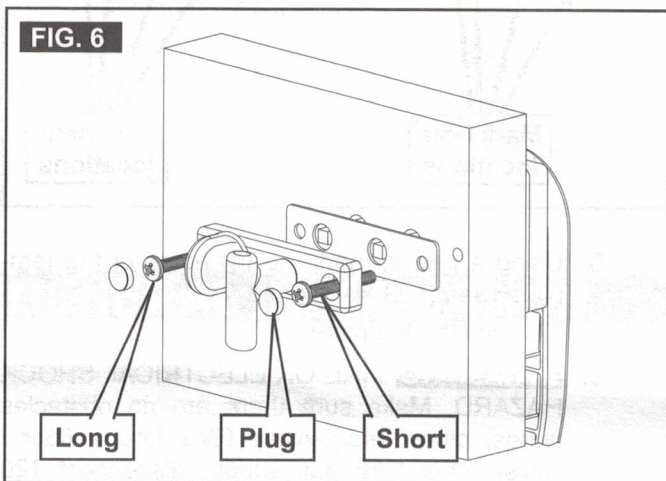

13. Assemble inside lock unit, with gasket, to outside lock unit, aligning with square shafts. See (FIG. 6).

(i) When assembling, with key removed and locking plate locked into any position, align cut-out of thumb turn with screw hole, and align long lobe of inside lever the same direction as locking plate. See (FIG. 7).

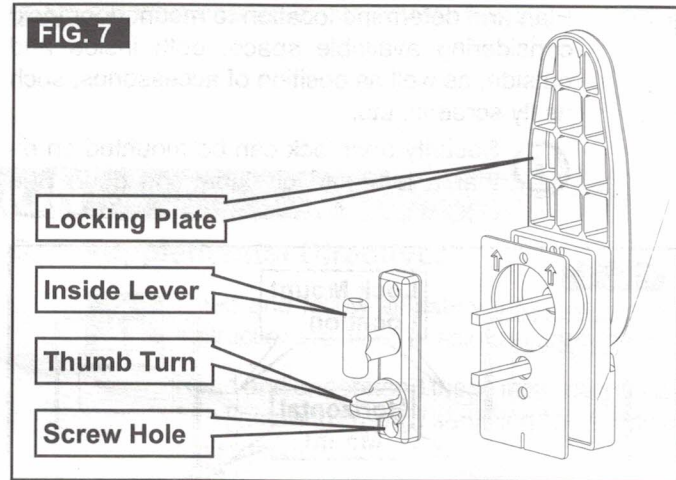

14. Secure units with (1) short and (1) long screw. Note location of each. See (FIG. 6).

(i) NOTE: Hand tighten screws.

15. Apply (2) plugs to holes, covering screws. See (FIG. 6).
16. Installation is now complete.