



# Installation Instructions

## Part # SS300U - Rear Trac Bar

This product is designed to eliminate the side shift of the rear axle on Chevrolet/Workhorse P32 chassis with rear disc brakes.

Installation time is 1-2 hours

\*A qualified mechanic using normal automotive tools and following all safety measures known should perform installation of this product. Components are shown below:

### SS300U TRAC BAR PARTS LAYOUT

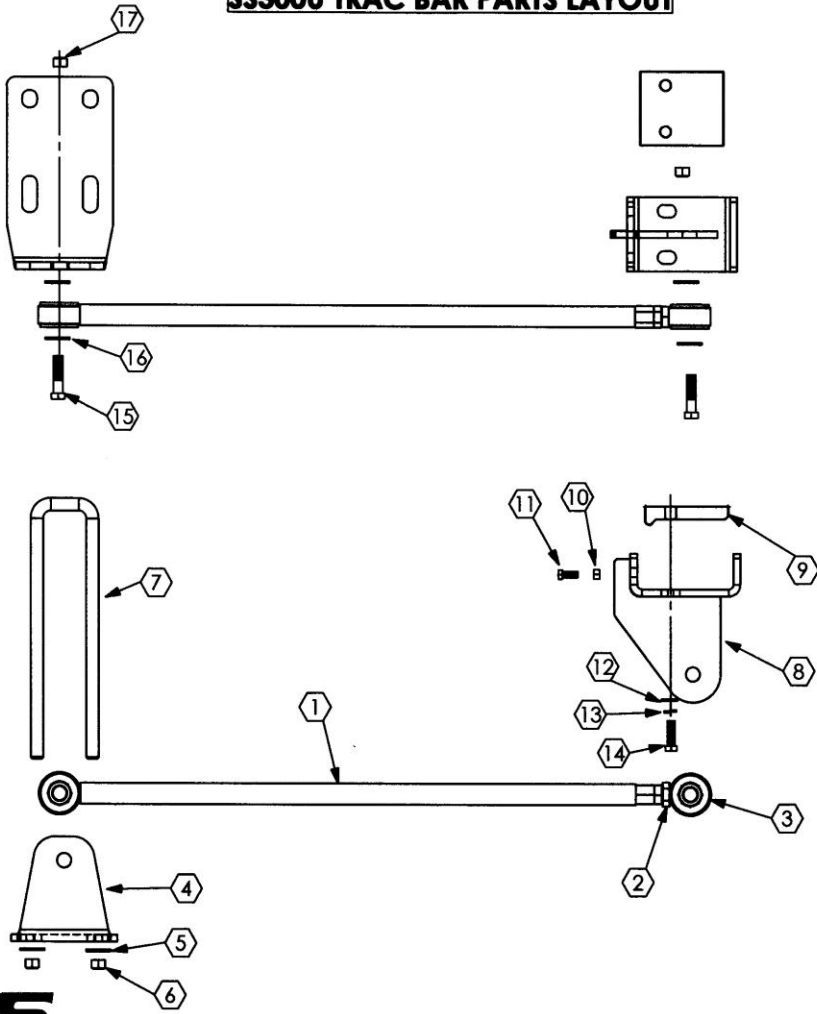

ITEM #	Description	QTY.
1	SS300U Rod Assy	1
2	Jam Nut - 3/4 16UNF	1
3	Rod End Assy	1
4	Axle Bracket	1
5	Flat Washer - 3/4	4
6	TopLock Nut - 3/4 16UNF	4
7	U-Bolt 3/4- 1/2x13 1/2 Sq. Top	2
8	Frame Bracket	1
9	Nut Plate	1
10	Nut - 1/2 20UNF	2
11	Bolt - 1/2x1 1/4 20UNF	2
12	Flat Washer - 5/8	2
13	Lock Washer - 5/8	2
14	Bolt - 5/8x2 18UNF	2
15	Bolt - 3/4x3 16UNF	2
16	Flat Washer - 3/4	4
17	Lock Top Nut - 3/4 16UNF	2

Item #	Torque Spec. (ft. lbs.)
2	100-150
6	140
10	securely
11	securely
14	securely
15	150-180



## Installation Instructions for Part # SS300U - Rear Trac Bar

- **Some parts are slightly modified per application; principle is still the same. Some exhaust and brake line modifications may be necessary. Exhaust should exit ahead of rear wheels to provide adequate clearance.**
- **The SS300TP Exhaust Kit is available to relocate exhaust line for proper clearance.**
- **The SuperSteer® SS300U Rear Trac Bar is designed to be mounted with the axle bracket on either the driver or passenger side with the frame bracket on the opposing side of the axle bracket. Typical installations have the axle bracket placed on the driver side with the frame bracket on the passenger side. Chassis that have large spacer blocks or wedges on the driver's side spring pack may not have enough of the U-bolts protruding to allow for proper installation. In these cases the SuperSteer® Trac Bar axle bracket may be mounted on the passenger side of the axle with the frame bracket on the driver's side or utilizing the longer U-bolts supplied in this kit.**

### ***A. Preparation***

Move the coach to a level, flat surface. If necessary, drive the rear wheels of the coach onto 4" high blocks and set the brakes or you may drive the coach over a work pit and chock the front wheels. Block off adequate space at the rear of the coach to work.

### ***B. Installation of the Axle Bracket***

Measure U-Bolt length extending past the OEM nuts, which should be at least 1 ½" long. If the U-bolts are of this length, do not remove the four (4) nuts on the rear axle U-bolts, but apply the axle bracket onto the U-bolts to verify enough threads to install the nuts. Attach the axle bracket with supplied lock-nuts and washers. Torque to 140 ft. lbs. U-bolts must protrude through the lock-nuts by at least two threads. If U-bolts do not protrude through the lock-nuts by at least two threads, install the new U-bolts provided in this kit.



## Installation Instructions for Part # SS300U - Rear Trac Bar

### C. Installation of the Frame Bracket

Install the frame bracket and nut plate to the frame rail. The frame must be between the nut plate and the Rear Trac Bar frame bracket. The Rear Trac Bar frame bracket is designed to mount to the bottom and sides of the frame rail. Position the bracket directly next to the rear frame cross-member (place the nut plate with lip facing down and towards center of vehicle). Make sure not to contact any wires, brake lines, etc. Install bolts through the bottom of the frame bracket and thread in to nut plate. *(Use blue Loctite and tighten "just snug" for now)*

Then install the jam nuts onto the ½-20 bolts and install on the frame bracket. Tighten to push the nut plate against the inside of the frame, and then tighten the bottom bolts securely. Now tighten the jam nut against the bracket to lock the ½-20 bolt from backing out.



### D. Installation of Rod Assembly

Adjust and mount the rod assembly (Rear Trac Bar attaches to rear of the brackets). Install bolts, washers and nuts. (Flat washers go on each side of urethane bushings.) Torque to 150 to 180 ft. lbs.

Note: When adjusting the length of the rod assembly, it is necessary that the coach's full weight be on the suspension.



## **Installation Instructions for Part # SS300U - Rear Trac Bar**

### ***E. Torque Specifications & Follow-Up***

Torque the Trac Bar jam nuts to 100-150 ft. lbs. Note: The Rear Trac Bar should be below the rubber brake hose. Protect the brake hose with convoluted tubing to prevent rubbing and possible failure.

Double-check the fasteners to make sure all are properly torqued.

Test drive. Complete and mail the warranty card.

Re-check torque in 6 months.

**Your comments are greatly appreciated. Please feel free to contact SuperSteer® at 888-898-3281 or e-mail at [john@supersteerparts.com](mailto:john@supersteerparts.com)**

**Thank you for your purchase of the SuperSteer® Rear Trac Bar.**