

- NOTES:
- ITEM 382270 TO BE MOUNTED ANYWHERE ALONG SHOWN SURFACE BUT AS CLOSE TO THE BRAKE LEVER AS POSSIBLE
 - USE AMP P/N 90287-1 OR WQUIVOLENT CRIMPING TOOL FOR INSTALLING PINS
 - PIN THIS SIDE ONLY -INSERT USING PRESS

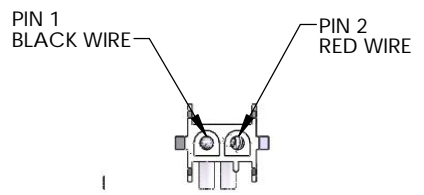
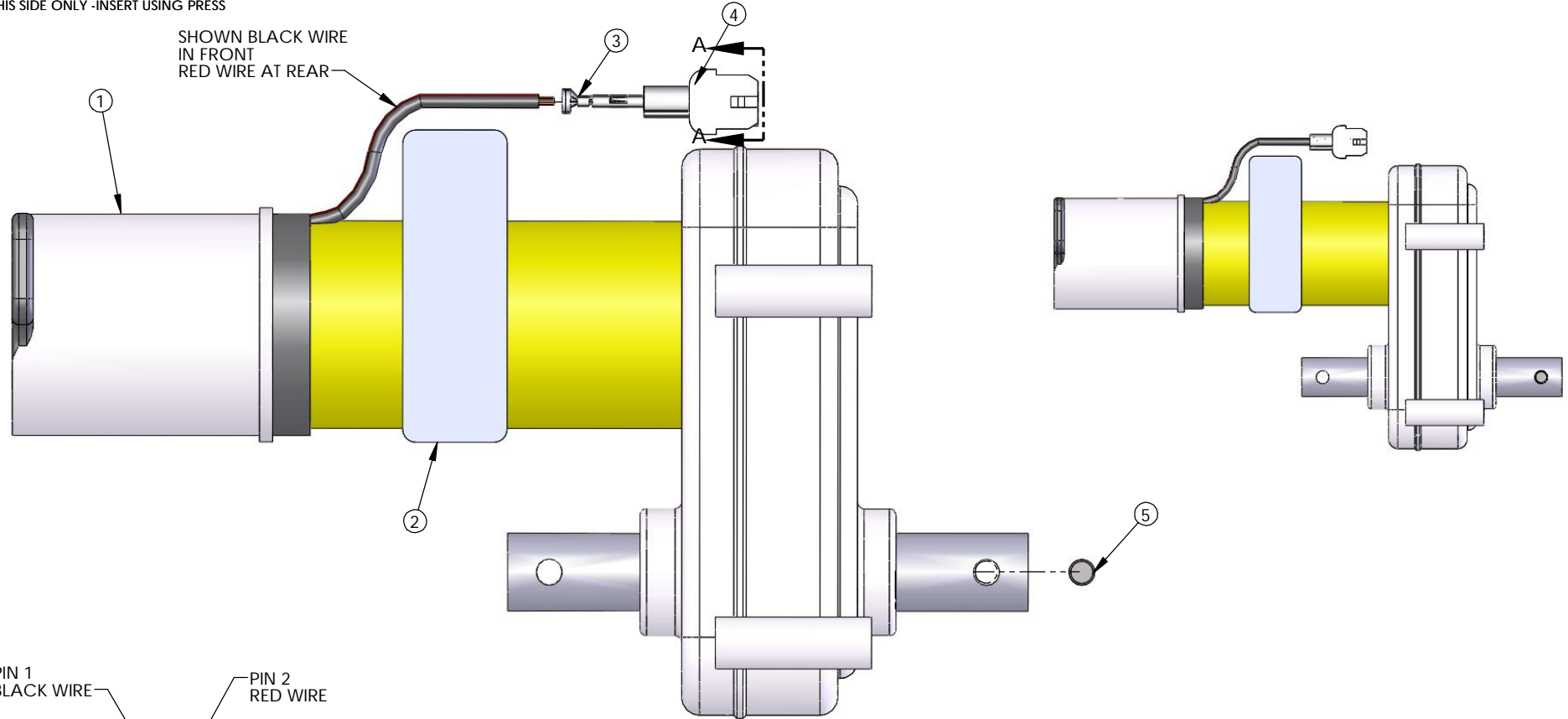

SECTION A-A
SCALE 1 : 1

ITEM	PART NO.	CONFIG	DESCRIPTION	NAME	GA	QTY.
1	368888	Default	GEARMOTOR DUAL SHAFT MT W/O PIN-B (130-1146)	MOTOR		1
2	382270	Default	DECAL, MOTOR BRAKE OVERRIDE (520216)	236 LABELS		1
3	368912	Default	PIN MALE AMP (14-1107)			2
4	368913	Default	CONNECTOR HOUSING 2 PIN FEMALE AMP MATE-N LOK (14-1108)			1
5	372452	Default	PIN, GROOVED 1/4" X 1 1/4"	FASTENER		1

TITLE: **MOTOR ASSY DS MT W/PIN CONN-B (522895)**

UNLESS OTHERWISE SPECIFIED 1. ALL DIMENSIONS ARE IN INCHES 2. BREAK SHARP EDGES & DEBURR 3. MATERIAL & FINISH TO BE AS NOTED OR SUBSTITUTED WITH AN APPROVED AND TESTED EQUIVALENT		TOLERANCES (EXCEPT AS NOTED) DECIMAL .X ± .1 .XX ± .010 .XXX ± .005 FRACTIONAL ± 1/16 ANGULAR ± 1°		THE INFORMATION CONTAINED IN THIS DRAWING IS THE SOLE PROPERTY OF LIPPERT COMPONENTS, INC. ANY REPRODUCTION IN PART OR AS A WHOLE WITHOUT THE WRITTEN PERMISSION OF LIPPERT COMPONENTS, INC. IS PROHIBITED.	
REFERENCE NUMBER: 522895 MATERIAL TYPE: SURFACE QUALITY: DECIMAL: FINISH GOOD WEIGHT: 1.837 BLANK WEIGHT: BLANK SIZE: X	FILLETS R.015 FINISH 125 THIRD ANGLE PROJECTION	DWG. NO: 383755 SIZE: B		DATE: 07/23/2015 SCALE: 1:4	REV: B

DRAWN BY: SKW CHECKED BY: SKW APPROVED BY: _____
 SHEET 1 OF 1