

**PARTS INCLUDED**

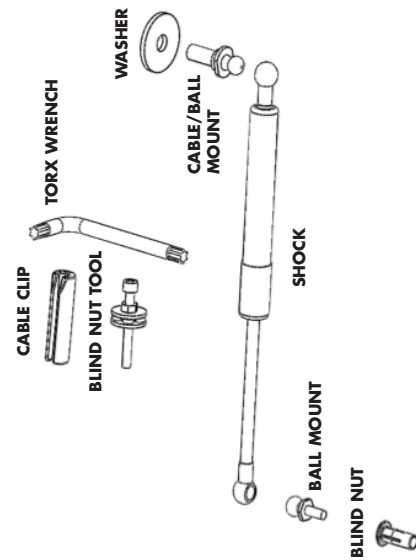

**PARTS LIST**

- SHOCK 1
- BLIND NUT TOOL 1
- CABLE/BALL MOUNT 1
- WASHER 1
- BALL MOUNT 1
- BLIND NUT/NUTSERT 1
- TORX WRENCH 1
- CABLE CLIP 1
- MAYLAR 1

**TOOLS REQUIRED:**

- T-45 TORX
- M5 ALLEN WRENCH
- PLIERS
- 10MM WRENCH
- 13MM WRENCH/SOCKET
- 17MM WRENCH
- TAPE MEASURE

**STEP 1**

**\* NOTE: THIS PRODUCT CAN ONLY BE INSTALLED ON THE DRIVER'S SIDE.**

Using a M5 Allen wrench and a 10mm wrench, install the blind nut in the opening by the tailgate pivot point. The nutsert should be tightened at least nine 360 degree turns. Mark one side of the nut and count the number of revolutions to insure the correct number of turns. After the nine turns, if the blind nut can still be moved or rotates, continue tightening an additional 1 - 2 turns. Re-check blind nut, repeat as needed.

Remove the nutsert tool when installation is complete.

**WARNING: Overtightening the nutsert can strip the threads and cause the nutsert to be unusable.**



**STEP 2**

Install the ball mount into the nutsert using a 13mm wrench/socket. Torque to 8 ft-lbs.



**STEP 3**

Remove the tailgate cable and use a T45 torx socket or the wrench provided to remove the cable bolt.

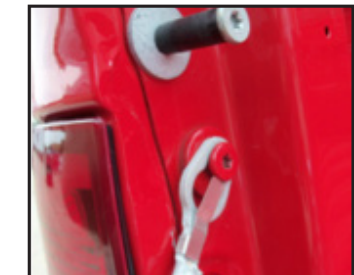

**STEP 4**

Using a 17mm wrench, install the cable/ball mount and washer where the factory bolt was removed in the previous step.



**STEP 5**

Install the tailgate cable onto the cable/ball mount.



**STEP 6**

Remove the other end of the tailgate cable with the T45 torx and remove the motion limiter.



The flat retaining nut must be taken off to remove the limiter.

**STEP 7**

To remove the limiter, pry up one edge of the flat nut with a screwdriver. Hold this edge with a pair of pliers and spin the bolt out of it.



Once the limiter is removed, reinstall the cable mount to the tailgate.

**STEP 8**

Measure down from the top of the cable 3 1/2". This is where the cable clip needs to start. Press the clip onto the cable with a pair of pliers.

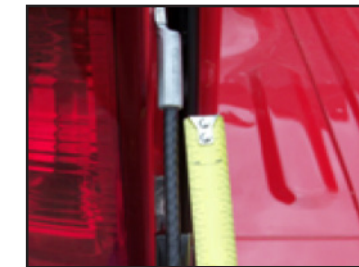

Failure to remove the limiter and to install the cable clip will cause the cable to bind or become caught between the shock and truck bed. This may lead to vehicle damage so these steps MUST be done.

**STEP 9**

A Mylar sheet has been provided to help prevent components from rubbing against the truck bed and tailgate in the event that any part becomes loose. Using scissors, cut the mylar to the size needed. Apply the mylar to the truck bed and tailgate where tailgate assist components will be in close proximity during opening/closing. The red lines show the area where the mylar has been installed.



The vehicle shown is an example of how the mylar can be installed. Your vehicle may differ from the vehicle shown.

**STEP 10**

Install the larger part of the shock on the cable/ball mount.



Install the narrow end of the shock on the ball mount.



\*Periodically check the upper and lower mounting locations to insure that parts have not loosened through repeated use. If either mounting location is found to be loose, re-tighten the hardware as needed.

## FAQ's

### Can the Tailgate Assist be installed on the passenger's side?

No. The unit will not work on the passenger side of the truck bed. Installing the tailgate assist on the passenger side can cause the tailgate to come off the truck.

### Are there installation videos?

Yes. All installation videos can be viewed at: [www.deezee.com/tailgateassist](http://www.deezee.com/tailgateassist)

## DEE ZEE, INC. WARRANTY COVERAGE

Dee Zee, Inc. guarantees the original purchaser a limited warranty against manufacturer defects in materials, workmanship, and design under normal use.

Tailgate Assist has a 3-year limited warranty. Operational and wear items such hardware have a one-year (1) warranty. To read the complete warranty policy for your product visit: [www.deezee.com/warranty](http://www.deezee.com/warranty)

Buyer assumes all risk, liability, and cost for the installation and use of Dee Zee products. Dee Zee, Inc. assumes no liability for injury, loss, incidental or consequential damages in the event of an accident.

## WARRANTY & RETURN SUBMISSION PROCEDURE

Please contact the original point of purchase for: shipping damage, returns, or warranty claims. Contact Dee Zee directly for missing parts or hardware.

All warranty claims will be initiated at the place of purchase. The original purchaser will be required to present the original sales receipt with purchase date shown and provide photographs of the defect.

## DZ 43300 DODGE RAM TAILGATE ASSIST 1500 2002-2008 2500/3500 2003-2009



**INSPECT YOUR PRODUCT FOR DAMAGE & MISSING PARTS BEFORE PROCEEDING TO INSTALLATION**

# 1-800-779-2102

**Mon – Thurs: 8:00am - 5:00pm | Friday: 8:00am - 4:00pm (CST)**

**[WWW.DEEZEE.COM](http://www.deezee.com)**

**REGISTER YOUR PRODUCT ONLINE: [www.deezee.com/registration](http://www.deezee.com/registration)  
VIEW INSTRUCTIONS ONLINE: [www.deezee.com/instructions](http://www.deezee.com/instructions)**

**⚠️ WARNING: Cancer and Reproductive Harm**  
[www.P65Warnings.ca.gov](http://www.P65Warnings.ca.gov)