



# Cartridge Change Instructions

QL3B Head  
With Shut-Off Valve

## CARTRIDGE REMOVAL

1. Shut off water and relieve line pressure. Fully lift built-in shut-off valve handle until it stops.
2. Hold head firmly. Turn cartridge to left 1/4 turn until rotation stops.

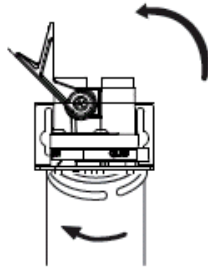

3. Pull cartridge down and out of head.

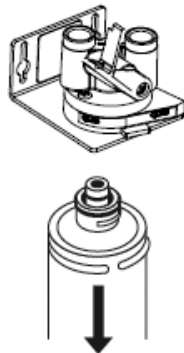

## CARTRIDGE REPLACEMENT

1. Align new cartridge lug with head label. Hold head firmly. Insert new cartridge into head.

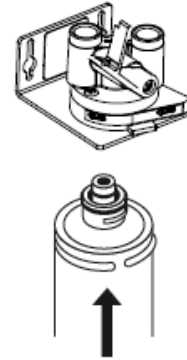

2. Turn cartridge to right 1/4 turn until rotation stops. On multiple head systems, repeat steps 2-5 for each cartridge.

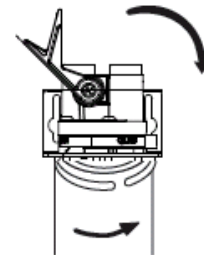

3. Turn on water supply by lowering shut-off valve handle.
4. **NOW FLUSH CARTRIDGE!** Run water through filter to drain for several minutes. **Refer to cartridge label for specific flushing time.**

For sales, replacement components, and service, contact your Everpure dealer or:  
Everpure, LLC: 1040 Muirfield Drive • Hanover Park, Illinois 60133 • 800.323.7873  
In Europe: Toekomstlaan 30 • B-2200 Herentals, Belgium  
In Japan: Hashimoto MN Bldg. 7F • 3-25-1 Hashimoto Sagamihara-Shi • Kanagawa 229-1103, Japan

Technical Service  
800.942.1153  
[www.everpure.com](http://www.everpure.com)