



Jeep Liberty



BASEPLATE

BOLT TORQUE SPECIFICATIONS

STANDARD BOLTS:			METRIC BOLTS:	
Size	Grade	Torque	Size	Torque
5/16"	5	20 ft/lbs.	8mm	22 ft/lbs.
3/8"	5	35 ft/lbs.	10mm	42 ft/lbs.
7/16"	5	56 ft/lbs.	12mm	70 ft/lbs.
1/2"	5	85 ft/lbs.	14mm	95 ft/lbs.

Pin height - 16-3/4"

Centers - 22-1/4"

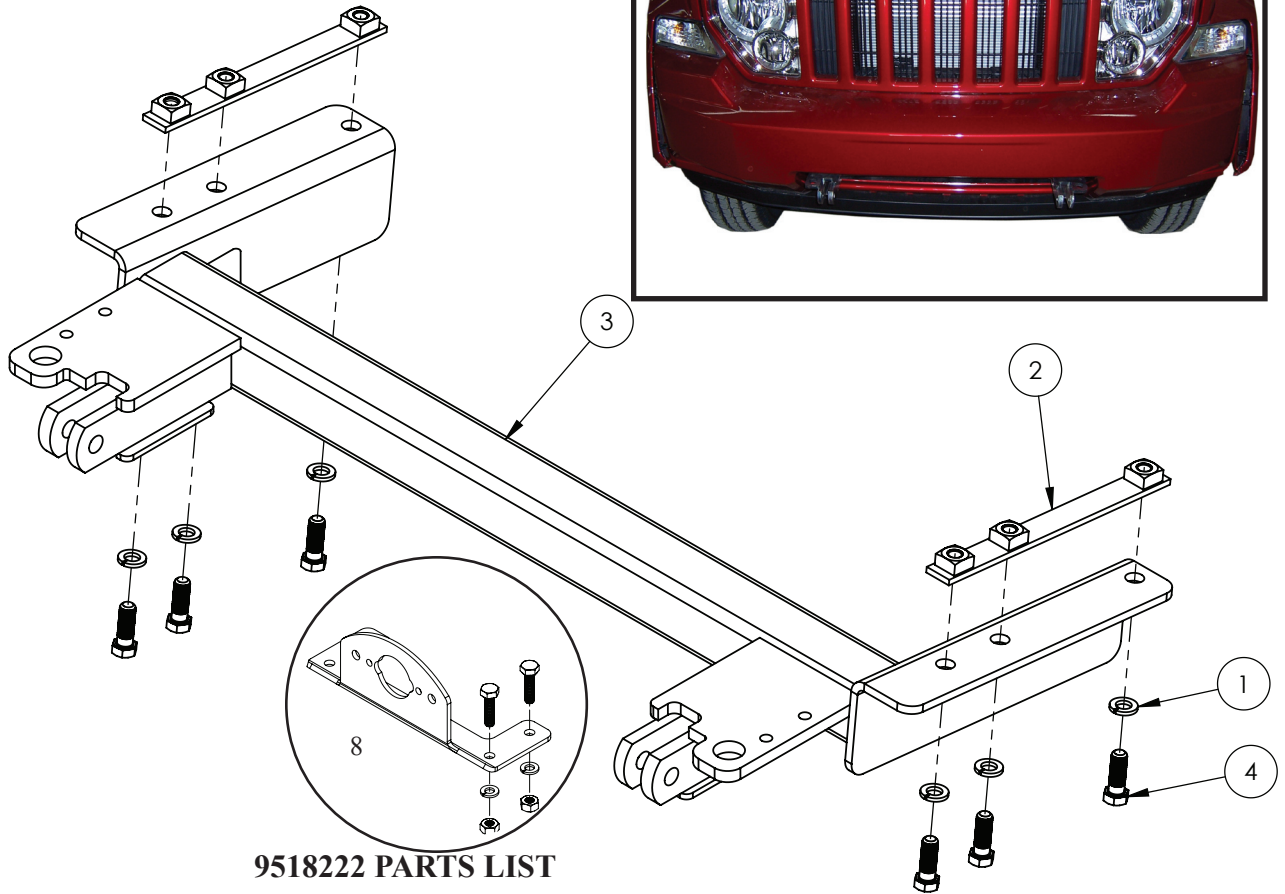

9518222 PARTS LIST

ITEM	PART #	QTY	DESCRIPTION
1	00078	6	WASHER, SPRING LOCK, .438
2	10876-35	2	NUT STRIP
3	13133-35	1	BASEPLATE CROSSMEMBER
4	01898	6	BOLT .438NC X 1.25 GR5 HEX
5	09551	4	PLASTIC POP RIVET (Not Shown)
6	12979	1	PULL EAR COVER "A" (Not Shown)
7	12980	1	PULL EAR COVER "B" (Not Shown)
8	5937	1	Plug Mount Kit
9	12329	1	LOCTITE (Not Shown)

Please order replacement parts by PART NO. and DESCRIPTION.

ASSEMBLY
OPERATION
REPLACEMENT PARTS

READ complete manual CAREFULLY
BEFORE attempting operation.

Doing Our Best to Provide You the Best

OPERATORS MANUAL

WARRANTY POLICY & REGISTRATION

Go online to www.demco-products.com to review Demco warranty policies and register your Demco product.

WARNING: FAILURE TO FOLLOW THESE INSTRUCTIONS CAN RESULT IN LOSS OF TOWING VEHICLE CONTROL, SEPARATION OF THE TOW BAR FROM THE TOWING VEHICLE, SEPARATION OF THE TOWED VEHICLE FROM THE TOW BAR, CAUSING SEVERE PERSONAL INJURY, DEATH, OR PROPERTY DAMAGE.

CAUTION

Safety is of utmost importance at all times. There are several items that must be checked each time before using and while using a tow bar.

Before allowing anyone to hook up or operate a tow bar, be sure they have read and understand the proper operating procedure.

DO NOT use worn or damaged cables and/or pins.

Be sure the **SAFETY CABLES** are hooked, chassis to chassis, to both the towing and towed vehicles using the crisscross method.

Check clearance between vehicles in a turning situation.

Check base plate mounting bolts for tightness and frame for metal fatigue.

Do not load the towed vehicle with anything as you may exceed the towing capacity of the tow bar.

Keep fingers away from pivot points to prevent personal injury.

Be sure the steering components of the towed vehicle are properly aligned.

NOTE: This unit can be backed up in moderate increments. Any severe backwards cornering could result in damage to the Tow Bar and/or towed vehicle chassis.

For automatic transmissions: Consult your vehicle owners manual for towing suitability with the drive shaft connected. Otherwise, the towed vehicle will have to be equipped with a transmission pump or drive shaft disconnect.

Check to make sure that all lights are in proper working order.

The information on towability of vehicles is reprinted with permission of MotorHome® Magazine, and is believed to be reliable. However, **Demco does not** warrant the information to be correct. Always consult your towed vehicle owner's manual and follow towing instructions. Each year, **MotorHome® Magazine**, compiles a list of vehicles that can be towed four-down behind a motorhome with no modifications required.

 **Caution: MotorHome® Magazine** left out any vehicles that have towing speed limits slower than 55 m.p.h., or distance limits of less than 200 miles. At a minimum, these vehicles require significant modification, such as the use of an aftermarket product, to make them towable. The availability of a **Demco Tow Bar Base Plate** does **not** imply that these vehicles can be modified or that there is an aftermarket product available. Refer to your vehicle owner's manual or consult your dealer to determine whether your vehicle can be modified to make it towable. Failure to observe this precaution could result in property damage or personal injury.

IMPORTANT INSTALLATION ITEMS

DEMCO products and accessories are intended to be installed by professional installers with experience, proper equipment and the ability to do modification work. Installers with these qualifications can be found in RV and Automotive Service Centers.

If the car to be towed has been in an accident, the chassis may be damaged in an area where the Base Plate attaches. It may no longer be suitable for towing. Extreme caution and careful examination are required in such a situation. It is also likely, even from a minor accident, that the hole alignment will be more difficult due to hole alignment problems.

Many DEMCO Base Plates are designed to use existing holes and hardware to mount the Base Plate to the towed vehicle. Even though the bolt is there, however, do not assume it is adequate for mounting the Base Plate. Manufacturers make many changes in hardware both within and between model years. Be sure the bolt is long enough to protrude past the nut a distance no less than 1/2 the diameter of the bolt, after the Base Plate is mounted. The threads should be in good condition. **We require that "LOCTITE® Blue" be used on all bolts.** If a new bolt is required, be sure it is SAE Grade 5 or Metric 8.8.

NOTE: The dimensional variations between otherwise identical vehicles can be considerable. Some minor modifications may have to be made to ensure a proper fit.

NOTE: The dimensional variations between other-



1. Drill out two plastic rivets from each wheel well.



2. Remove three plastic push fasteners from each wheel well.



3. Release three plastic fasteners from fender flare to fascia.

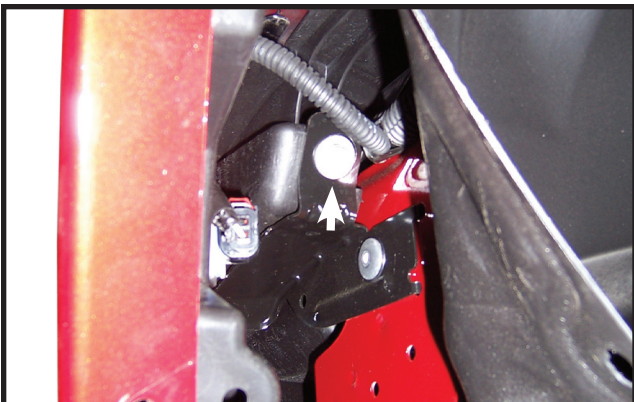

4. Remove one bolt on each side inside of wheel well.

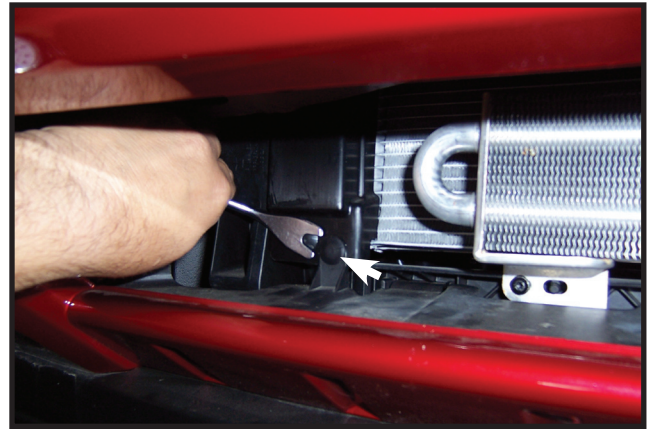

5. Remove two plastic push fasteners from fascia opening.
NOTE: Skip this step on 2011 Liberty

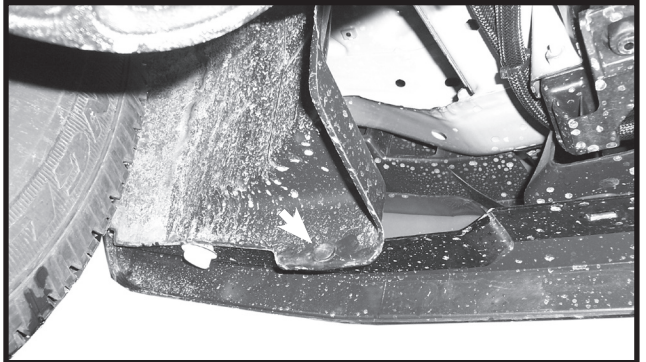

6. Remove one (two if equipped) plastic push fasteners from bottom of wheel well to fascia.

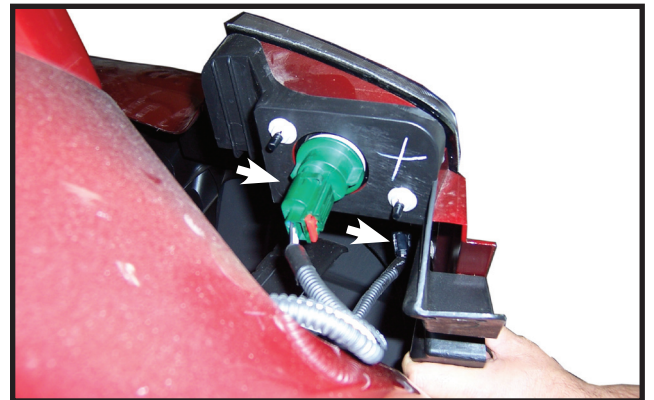

7. Start removing fascia enough to unplug front fascia wiring on each side (slide red lock back, then release), remove fascia.



8. Remove both tin covers on front of bumper to allow access for nut strip.
NOTE: If jeep is equipped with tow hooks and or front skid plate these will be removed and not reused.

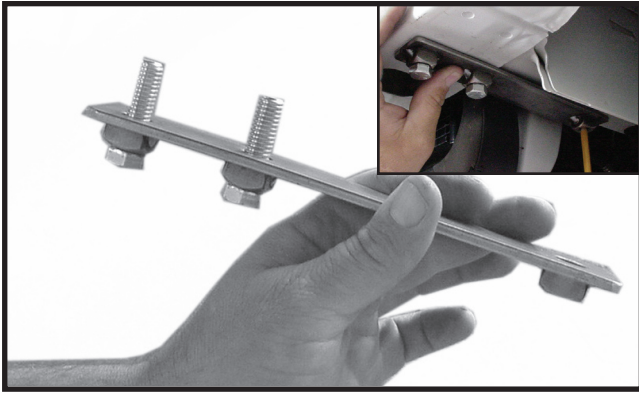

9. Install two bolts into nut strip and insert bolts into front frame holes and mark hole.



10. Drill with 1/2" drill bit.

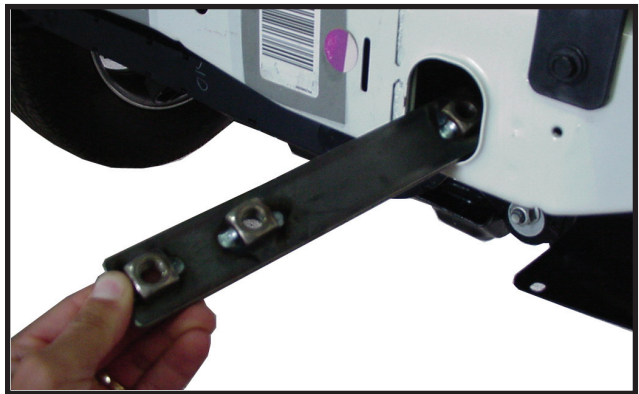

11. Remove two bolts and insert nut strip into end of frame, nuts on nut strip up.

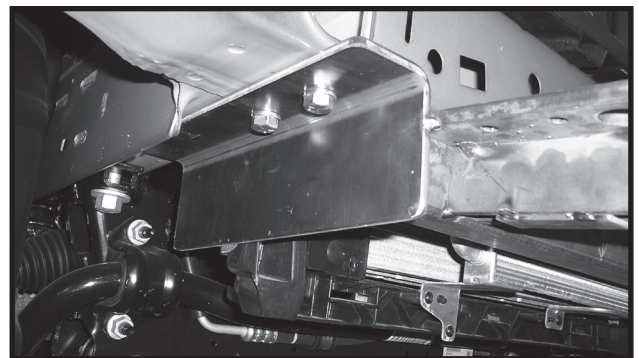

12. Remove cooler hose clip from frame and move down if equipped. With an assistant install base plate with six 7/16" x 1-1/4" bolts and 7/16" lock washers. **NOTE:** Use **LOCTITE**® Blue on all bolts.

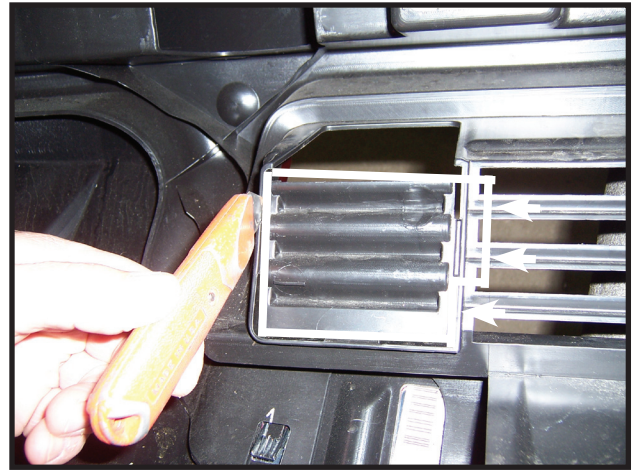

13. **2011 Liberty Only** Cut fascia as shown in picture. Trim as needed. **NOTE:** Back view shown.



14. Reinstall tin covers on both sides, fascia and all previously removed fasteners and plug in light connector. Use rivet installation below to install new rivets. If equipped with lower grill remove or trim as needed.
15. Plug mount (item #8) may be installed if desired in convenience holes on either chain anchor or as desired. **NOTE:** Excess material may be trimmed from bracket.

PLASTIC RIVET INSTALLATION ON BACK PAGE

PLASTIC RIVET INSTALLATION



1. Insert plastic rivet into existing holes.



2. Use pliers as leverage tool for vise grip.



3. Use vise grip on rivet, and roll on pliers as shown.



4010 320th St., P.O. BOX 189, BOYDEN, IA. 51234
PH: (712) 725-2311
FAX: (712) 725-2380 or 1-800-845-6420
TOLL FREE: 1-800-54DEMCO (1-800-543-3626)
www.demco-products.com

**Go online to www.demco-products.com for Demco
warranty policies & product registration.**